

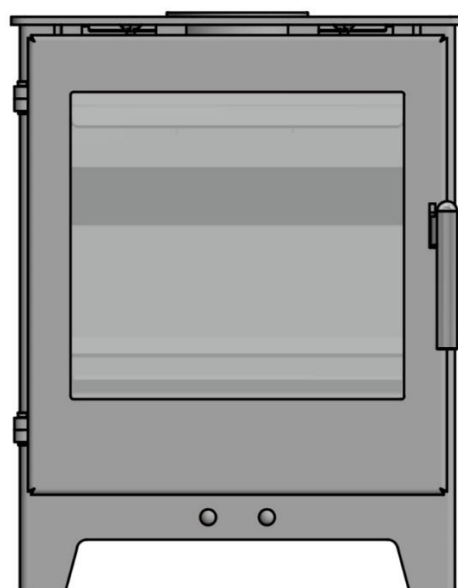

# BRIGHTWELL 400 P

**5.0kW Portrait Multi-Fuel Stove**



## INSTALLATION & OPERATING INSTRUCTIONS

This appliance is hot while in operation and retains its heat for a long period of time after use. Children, aged or infirm persons should be supervised at all times and should not be allowed to touch the hot working surfaces while in use or until the appliance has thoroughly cooled.

This stove has an Efficiency Rating of “A+” and has passed the Eco-design 2022 Standard and has met the Standards as defined by DEFRA for Burning Wood in Smoke Free Areas  
(Can only be used in a Smoke Free Zone when the DEFRA kit is fitted – please refer to page 8)

---

## CONTENTS

1.	Installation Information & Technical Data...	
2.	Installation Checklist .....	
3.	Important Operation/ Maintenance Notes .....	
4.	Installation & Operating Instructions .....	
5.	General .....	
6.	Flues .....	
7.	Chimney .....	
8.	Flue Exit (Top and Rear) .....	
9.	Down Draughts .....	
10.	Ventilation & Combustion Air Requirements .....	
11.	External Ducted Air .....	
12.	Heat Recovery Ventilation (HRV) .....	
13.	Location .....	
14.	Clearance To Combustibles .....	
15.	Floor Protection .....	
16.	Stove Dimensions .....	
17.	Commissioning and Handover .....	
18.	Operation .....	
19.	Air Controls .....	
20.	Recommended Fuels .....	
21.	Technical Data .....	
22.	Lighting .....	
23.	Lighting The Stove .....	
24.	Refuelling .....	
25.	Slow Burning .....	
26.	Disposal of Ashes .....	
27.	Monthly Maintenance .....	
28.	Periodic Maintenance .....	
29.	Chimney Cleaning .....	
30.	Glass Cleaning .....	
31.	Cleaning a Matt Black Stove .....	
32.	Prolonged Periods of Non Use .....	
33.	Fire Safety .....	
34.	Glass Replacement .....	
35.	CO & Smoke Alarms .....	
36.	Exploded View & Parts List .....	
37.	Appendix 1 - Annual Servicing Records .....	
38.	Detailed Warranty. ....	
39.	Energy Efficiency Label Europe & the United Kingdom .....	

## Important Key Safety Points: *Please read before using your stove*

### WARNING



**HOT  
SURFACES**



**ALWAYS WEAR  
GLOVES WHEN  
HOT**



**ONLY USE  
APPROVED FUELS**



**DO NOT  
OVERLOAD THE  
FIREBOX**



**FIT A CARBON  
MONOXIDE (CO)  
ALARM IN THE  
ROOM WHERE  
THE STOVE IS**



**CURE THE PAINT  
CORRECTLY**



**HEAVY  
THIS PRODUCT IS  
HEAVY FOR  
INSTALLTION USE  
THE CORRECT  
LIFTING  
PROCEDURES**

***HOT - HOT - HOT This appliance and the flue will become HOT while in operation and retains its heat for a long period of time after use. Children, aged or infirm persons & pets should be supervised at all times and should not be allowed to touch the hot working surfaces while in use or until the appliance has thoroughly cooled.***

- *Always use the heat proof glove provided when touching the appliance*
- *All surfaces can be HOT*
- *WARNING! Keep children and pets away*
- *Do NOT cover or leave flammable substances or any combustible materials on or near the appliance such as soft furnishing, laundry or curtains*
- *Ensure a Carbon Monoxide (CO) alarm is fitted in the room where the stove is fitted, we also recommend the installation of a Smoke Detector as well*

**Only Approved Fuels to be used on this stove - which are:**

- *Seasoned Wood Logs or Kiln Dried Logs with a moisture level of less than 20%*
- *Smokeless Mineral Fuels as detailed on pages 18 & 26*
- *Keep all fuels loads 75mm below the AIR holes at the back of the fire box*
- *Do not overload the Fire box*
- *When COLD - Always empty the Ash Pan out after each time it is used*
- *Check the flue regularly for any blockages*
- *Do not leave unattended if children are in the room*
- *Do not clean when hot, or whilst fire is still alight*

***For installation - This Product is HEAVY - DO NOT try and LIFT it manually – Ensure correct and adequate handling facilities are used for unloading, site handling and installation***

### **First Time of Operation**

Before lighting this stove, ensure that all packaging, safety stickers and any protective wrapping have been removed, and that the glass has been cleaned, including all fingerprints from the glass.

Ensure that the room is adequately ventilated, the first time the stove is lit; we would recommend opening windows if possible.

### **Curing the Paint – First Time Usage**

- **Open the door by 20mm so the door rope seal is not touching the body for the first 20 to 30 minutes of burning**
- **Run the appliance at a 25% setting for a 1 hour**
- **Then at a 50% Setting for 1 hour**
- **Then Finally on Full Power 100% for 1 hour**

***This will then allow the paint the opportunity to fully cure. During this period it is possible for some fumes and vapours to be given off. We would recommend keeping children and pets out of the area at this time. If the paint is not cured correctly it could peel from the stove, so undertaking the curing process correctly is important***

## Installation Information

Please complete the following form for reference when required:

Ref.	Description	Please Complete
1	Which retailer did you purchase the stove from?	Name & Address of Retailer:
2	What date did you purchase your new stove?	Date:
3	What was the name of the approved fitter that installed your stove?	Full Name:  Contact Number:
4	What is the installer HETAS Registration Number?	HETAS Registration No.:
5	What is the serial Number of your stove? <i>This can be found inside the front door above the bottom hinge</i>	Serial Number:
6	What date was your stove installed?	Date:
7.	The Name, Model & Fuel Type reference for this stove is	Name - Brightwell 400 P Fuel Type – Multi-Fuel

## Technical Data Summary:

Reference	Description	Data
1	Maximum Heat Output – High Burn	5.0 kW Nominal Heat
2	Minimum Heat Output – Low Burn	2.0 kW
3	Efficiency %	84.8% (Wood) 81.5% (MSF)
4	Energy Label Rating (EEL Eco Labelling)	“A+”
5	Eco-Designed Status	Eco-Design Approved 2022
6	Approved for use in DEFRA Smoke Free Zone	YES

## KEY STOVE TECHNICAL DATA

### ALSO ADDRESSING ECO-DESIGN 2022 AND DEFRA SMOKE EXEMPTION

<b>Model Reference:</b>	<b>Brightwell 400 P – Multi-Fuel Stove</b>
<b>Energy Efficiency Class of Model:</b>	<b>A+</b>
<b>Net Efficiencies:</b>	<b>Wood: - 84.8% &amp; Ancit (Smokeless Fuel): 81.5%</b>
<b>Eco-Design Standard 2022 Compliant:</b>	Yes – Approved to the Standard
<b>Direct Heat Output:</b>	<b>5.0 kW</b>
<b>Indirect Heating Functionality:</b>	No – Air to Air Convectional & Radiant Heat only – No Hot Water
<b>Type of Heat Output Room Temperature Control:</b>	Two or more manual stages, no temperature control
<b>Other Control Options:</b>	N/a
<b>DEFRA – Compliant to the Standard:</b>	Yes – Approved to be used in Smoke Exempt Zones/Areas only when DEFRA kit is fitted – please refer to page 8
<b>Hearth Construction – Approved for:</b>	Superimposed 12mm thick - Non-Combustible Hearth such as (Glass, Steel, Stone or Concrete)
<b>Flue Collar &amp; Flue Pipe Diameter:</b>	Fit 128-130mm diameter (5.0") Flue (Single or Twin Walled)
<b>Approved Fuel Types:</b>	Multi-fuel – Dried Wood (less than 20% moisture) & Smokeless Mineral Fuels as detailed on pages 18 & 26
<b>Stove Construction:</b>	<ul style="list-style-type: none"> <li>- Steel Outer Stove Body &amp; Lid</li> <li>- Steel Door &amp; Handle (<i>Handle with Stainless Steel Outer</i>)</li> <li>- 4mm thick - Ceramic Heatproof Glass</li> <li>- Vermiculate High Temperature - Firebox Liner</li> </ul>
<b>3 way Air Management System:</b>	Primary, Secondary & Tertiary Air Inlets via 2 x Controls Knobs
<b>External Air Input kit:</b>	Yes – Optional Extra
<b>Stove Directly Fits onto a Log-Store:</b>	Yes – Pevex Log-Store Stand 350mm high - Optional Extra
<b>Top or Rear Flue Exit:</b>	Yes - Top or Rear Flue Exit options built in
<b>Rear Heat Shield:</b>	Yes – Rear Heat Shield Fitted as Standard onto the Rear of the Stove
<b>Convection &amp; Radiant Heat Sources Outputs:</b>	Yes – Radiant Heat from Both Sides & Front, with Additional Convectional Heat Ducts from the Rear & Top Outlets
<b>Warranty Period:</b>	5 years – (Excluding Consumable Items – see Operating Manual for full details)
<b>Log Length:</b>	325 mm in Length
<b>Sweep Flue through Stove:</b>	Yes – 2 x Removable Top Baffle Plates to Sweep
<b>Grate Type:</b>	Multi-Fuel Grate - Complete with Ash Pan Underneath
<b>Adjustable Bottom Feet for Levelling:</b>	4 x M6 pads fitted to the bottom of feet for adjustment
<b>What's included with this Stove:</b>	Glove, Ash Pan & Handle, Flue Collar, Rear Heat Shield Flue Collar, Log Retainer & Rear Flue Exit Blanking Plate (Fitted to the Stove)
<b>Minimum Flue Height/Pascals Rating:</b>	4.6m High and the flue tested at 12 Pascals

### STOVE EFFICIENCY & PERFORMANCE:

Fuel Type	Efficiency (%)		Energy Efficiency Index	Nominal Heat Output (kW)			CO (% @13% Oxygen)
	Net	Gross		Total	To Space	To Water	
Wood Logs	84.8%	77.5%	113	5.0 kW	5.0 kW	N/a	0.11
Maxibrite (MSF*)	81.5%	79.4%	N/A	4.9 kW	4.9 kW	N/a	0.05

**\*MSF = Manufactured Smokeless Fuel – Refer to Refueling & Approved Fuels Only on pages 18 & 26**

## STOVE EFFICIENCY & PERFORMANCE:

SPACE HEATING PERFORMANCE AT NOMINAL OUTPUT						
Fuel(s)	Primary Fuel	Seasonal Efficiency (%)	(mg/m <sup>3</sup> )			
			PM	OGC	CO	NOx
Wood Logs	Yes	74.8	25	109	1375	92
<b>Maxibrite (MSF*)</b> Smokeless Fuel	No	71.5	21.0	13	625	91

PERFORMANCE WHEN OPERATED ON PRIMARY FUEL						
Rated Heat Output (kW)	5.0	Nominal Net Efficiency (%)			84.8%	
Electrical Consumption Nominal (kW)	N/A	Electrical Consumption Minimum (kW)			N/A	
Electrical Consumption Standby (kW)	N/A	Energy Efficiency Index	113	EI Rating	A+	

### Specific Precautions during Assembling, Installing & Maintenance:

*See installation instructions for more information*

### PRODUCT RECYCLING:

**Product End-of-Life/Recycling:** *To dispose of the stove after the product life has expired, please observe the following information*

- ✓ *Dispose of the items correctly i.e. separate the parts to be disposed of in material groups*
- ✓ *Always dispose of items in a way that is as sustainable as possible and that is in line with the current environmental protection, reprocessing/recycling and disposal technology*
  - ALL METAL PARTS TO BE RECYCLED
  - ALL GLASS TO BE RECYCLED
  - ALL OTHER COMPONENTS TO BE DISPOSED IN A MANNER ACCORDING TO ENVIRONMENTAL REGULATIONS

### MINIMUM DISTANCES TO COMBUSTIBLE MATERIALS:

Refer to the table below these measurement assume the stove heat output is no greater than 5.00 Kilowatts

MINIMUM DISTANCES TO COMBUSTIBLE MATERIALS:	Minimum Distances to Combustible Materials (Walls)	
Flue Fitted – Main Rear Stove Rear Heat Shield Panel Fitted as Supplied	Back Wall	Side Wall
Fitted with twin walled insulated flue and rear heat shield panel fitted	200mm	500mm
Fitted with single walled flue with rear heat shield panel fitted	350mm	550mm

### MINIMUM DISTANCES TO NON-COMBUSTIBLE MATERIALS:

**We recommend a minimum clearance of 100mm to both sides & the back of this stove when being installed next to NON - COMBUSTIBLE MATERIALS into a fireplace opening constructed of solid brickwork**

**OVERALL STOVE DIMENSIONS – please refer to dimensional drawings below**

<b>Height:</b>	568mm - (Excluding Top Flue Collar)
<b>Width:</b>	445mm - (Including the Overhang of the Top Lid)
<b>Depth:</b>	323mm - (Excluding the Overhang of the Handle to the front & Rear Air Kit)

**STOVE DRAWINGS WITH KEY DIMENSIONS:** *(Drawings Not to Scale)*

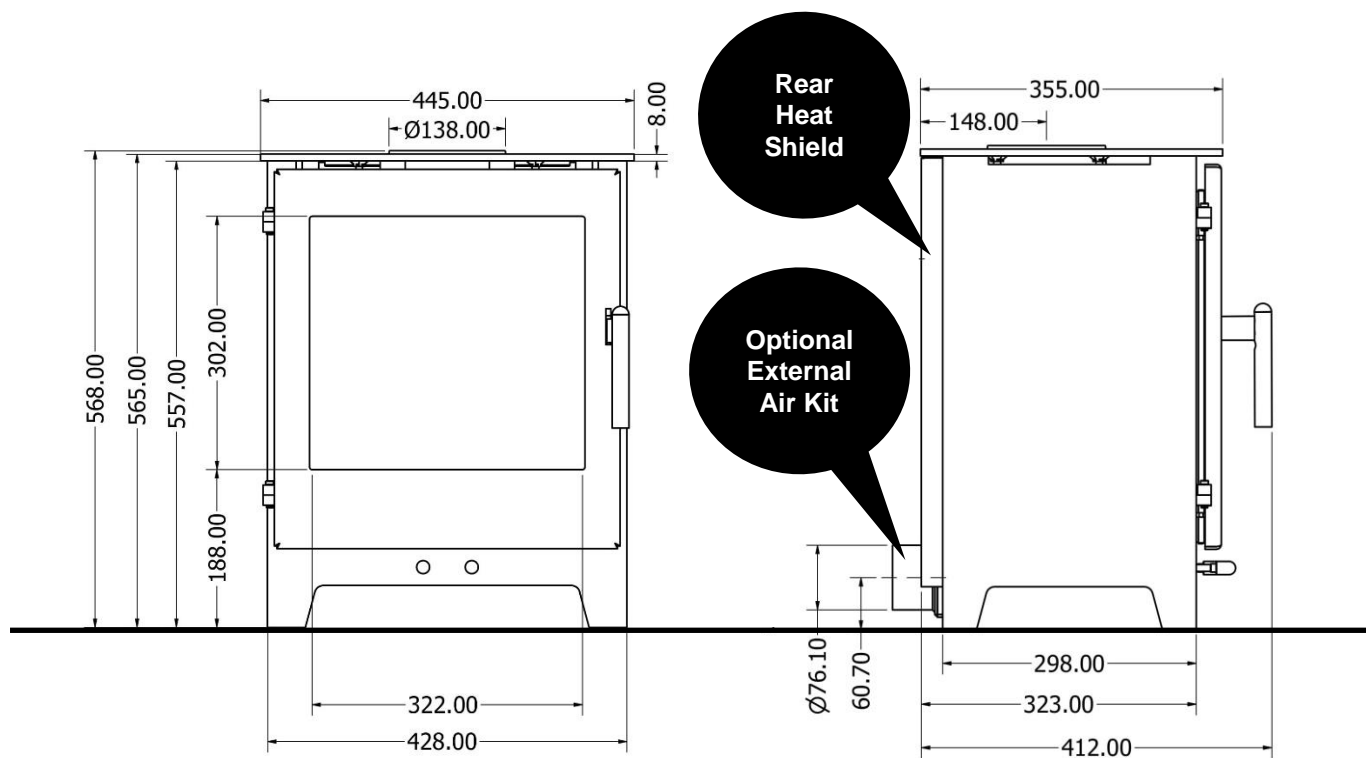

**Front View**

**Side View**

*(Showing Rear Heat Shield Fitted & Optional External Air Kit)*

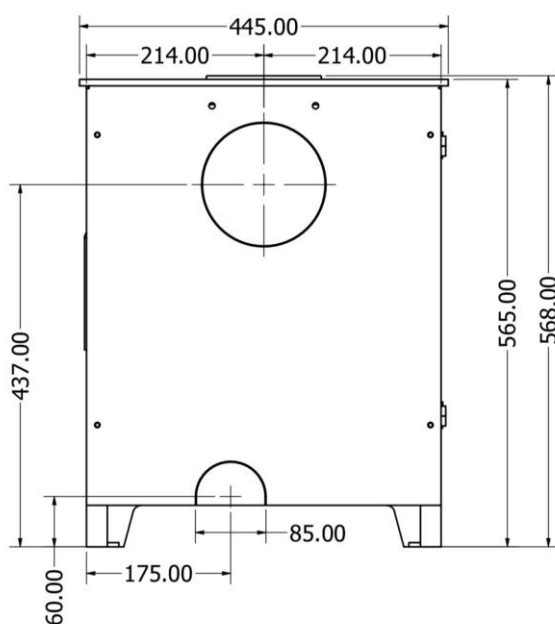

**Rear View**

*(Showing Rear Flue Exit Option & Optional External Air Kit Position)*

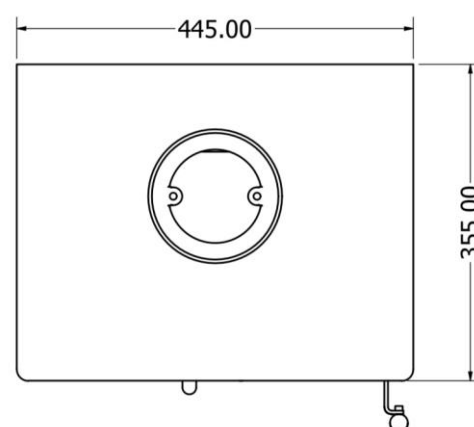

**Top View**

*(Showing Top Flue Exit Option)*

**EU Commission Delegated Regulation (EU) 2015/1186 - Energy Labelling of Local Space Heaters  
CE APPROVED & TESTED TO - BS EN 13240:2001 + Amd 2:2004**



## THE CLEAN AIR ACT 1993 AND SMOKE CONTROL AREAS – DEFRA LISTING

This Brightwell Multi-fuel stove is able to be used smoke controlled areas but only under the following conditions

- Correct Approved fuel is used, with a moisture content of less than 20%
- The limiter kit is fitted to the Secondary and Tertiary Air Control Rod
- The stove is not overloaded with fuel
- The stove is operated as stated in the operating manual supplied
- The stove is not overloaded with fuel
- Refuelling onto a low fire bed in the correct manner
- Not operating the stove with door left open

Under the Clean Air Act local authorities may declare the whole or part of the district of the authority to be smoke control area. It is an offence to emit smoke from a chimney of a building, from a furnace or from any fixed boiler if located in a designated smoke control area.

It is also an offence to acquire an “unauthorised fuel” for use within a smoke control area unless it is used in an “exempt” appliance (“exempt” from the controls which generally apply in the smoke control area)

In England appliances are exempt by publication on the list by the Secretary of State in accordance with changes made to sections 20 and 21 of the Clean Air Act 1993 by section 15 of the Deregulation Act 2015. Similarly in Scotland appliances are exempt by publication on the list by Scottish Minister under section 50 of the Regulatory Reform (Scotland) Act 2014

In Wales and Northern Ireland these are authorised by regulations made by Welsh Ministers and by the Department of Environment respectively

Further information on the requirements of the Clean Air Act can be found here at:  
<https://www.gov.uk/smoke-control-area-rules>

Your local authority is responsible for implementing the Clean Air Act 1993 including designation and supervision of smoke control areas and you can contact them for details of the Clean Air Act requirements

## REQUIREMENTS FOR THIS BRIGHTWELL STOVE WHEN BEING USED IN A SMOKE CONTROLLED AREA

### APPROVED FUELS TO BE USED

What can I burn in my Brightwell Multi-fuel Stove - When using this clean burn stove we recommend you use kiln dried or well seasoned wood with a **moisture content of less than 20%** this will give you the optimum burn and the highest efficiency with minimal smoke which emits the harmful Particulate Matters (PMs) into the environment. This will also give you maximum heat output and use the minimal amount of wood.

When burning Green wood or unseasoned wood with a moisture content of greater than 20% you risk discolouration on the door glass and it will most likely use up to twice the amount of fuel to achieve a lesser heat output than if you used the correct fuel. Using Kiln dried or well-seasoned wood will give you greater heat outputs, improved efficiency and therefore running costs, all of which is kinder to our environment and the air that we breathe

### FUEL OVERLOADING

The maximum amount of fuel specified in this manual should not be exceeded, overloading can cause excess smoke. **DO NOT PLACE LOGS HIGHER THAN 75MM (3 INCHES) BELOW THE TERTIARY AIR HOLES ON THE BACK FIREBOARDS**

### REFUELLING ONTO A LOW FIRE BED

If there is insufficient burning material in the firebed to light a new fuel charge, excessive smoke emission can occur. Refuelling must be carried out onto a sufficient quantity of glowing embers and ash that the new fuel charge will ignite in a reasonable period. If there are too few embers in the fire bed add suitable kindling to prevent excess smoke.



## AIR MANAGEMENT DAMPERS LEFT OPEN

Operation with the air control or appliance dampers open can cause excess smoke. The appliance must not be operated with air controls, appliance dampers or door left open except as directed in the instructions.

## OPERATION WITH DOOR LEFT OPEN

Operation with the door open can cause excess smoke. The appliance must not be operated with the appliance door left open except as directed in the instructions.

## REQUIREMENTS FOR THIS BRIGHTWELL STOVE WHEN BEING USED IN A SMOKE CONTROLLED AREA

The Brightwell Multifuel Stove has been recommended as suitable for use in smoke control areas when burning wood logs. The Brightwell Multifuel Stove must be fitted with a permanent stop to prevent closure of the secondary/tertiary control rod beyond the 11.5mm open position. **The DEFRA limiter supplied with the stove must be fitted to meet the requirements before use of the stove**

## FITTING THE DEFRA LIMITING FIXTURE TO THE STOVE TO COMPLY WITH THE CLEAN AIR ACT AND DEFRA

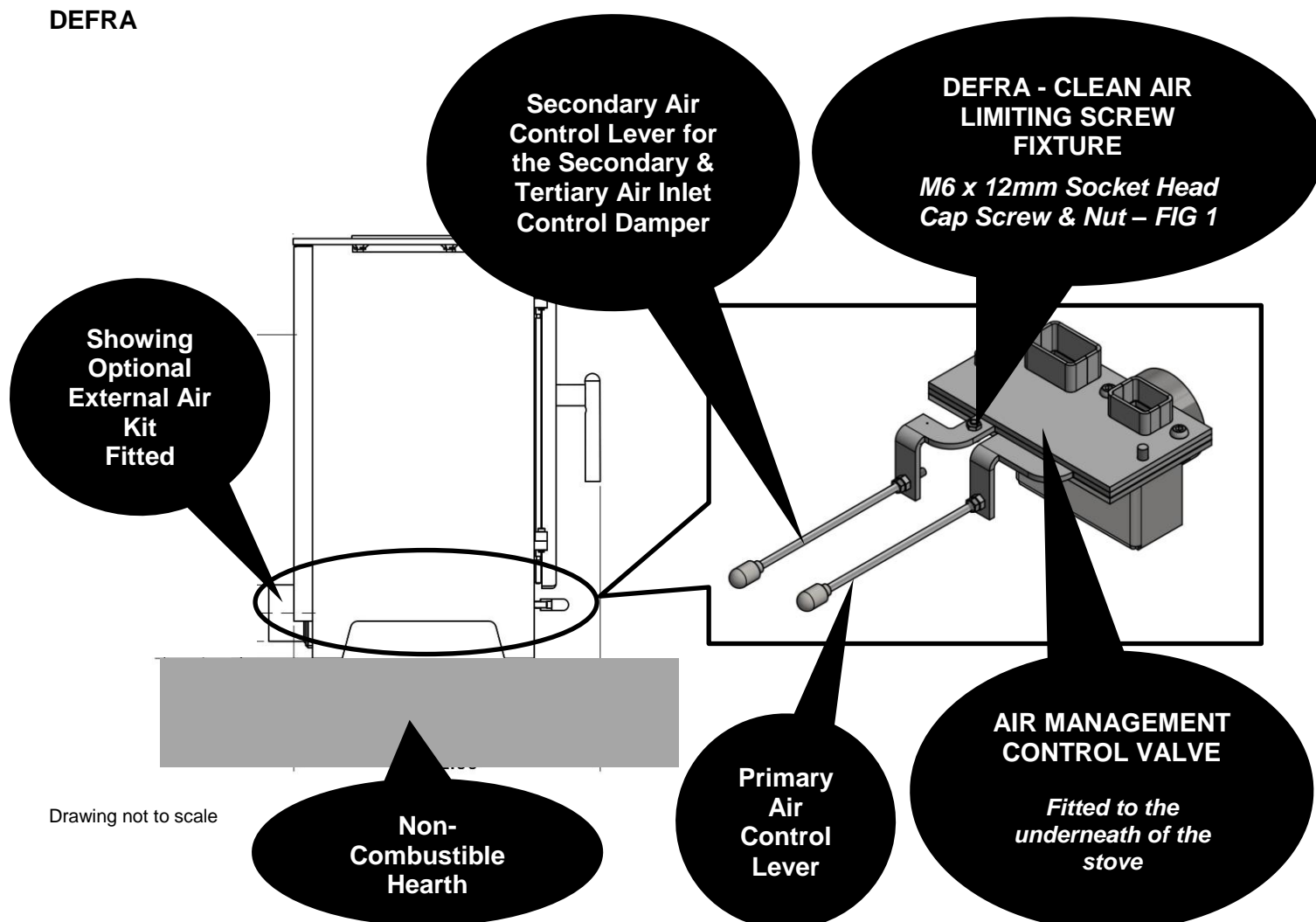

### INSTRUCTIONS ON HOW TO FIT THE DEFRA LIMITING SCREW FIXTURE

**1** If not ready fitted to your stove please fit a M6 x 12 Capscrew & Nut before the stove is installed other you will not be able to fit it once the stove is installed.

**2** Pull out the Secondary Air Control lever and it will expose the hole in the paddle, Fit the M6 x 12 Capscrew & Nut as shown in Fig 1 above

**NOW THIS IS FITTED THIS STOVE CAN BE USED IN A CLEAN AIR CONTROLLED AREA. BY FITTING THIS LIMITER THIS WILL PREVENT THE SECONDARY SLIDER FROM FULLY CLOSING AND REDUCE THE SMOKE OUTPUT OF THE STOVE**

## BRIGHTWELL SOLID FUEL STOVE WARRANTY

### CONDITIONS OF WARRANTY

Your Brightwell Solid Fuel Stove is guaranteed against any part that fails (under normal operating conditions) as detailed in the following table with timelines specified from the date of installation of the appliance. If the unit is not installed within three months of date of purchase, the warranty will commence three months from the date of purchase.

Warranty Period	Parts Covered (Parts Supply Only)
Up to 1 Year	<ul style="list-style-type: none"> <li>Grates</li> <li>Ceramic glass is covered for Thermal breakage only – Crazing of the glass is not covered</li> <li>Aesthetic Damage at point of purchase only (provided reported damage and photos (date marked) are submitted along with a dated receipt from a Pevex approved retailer)</li> <li>Paint finish – under normal firing conditions</li> </ul>
Up to 5 Years	<ul style="list-style-type: none"> <li>All external castings and the main stove body (excluding impact damage or damage caused by over-firing). Pictures of damage must be submitted to Pevex Service Department.</li> </ul>
Items deemed as CONSUMABLE items are not covered by the Warranty	<ul style="list-style-type: none"> <li>Refractory materials (internal fireboards)</li> <li>Rope seals, glass seals and cement seals.</li> <li>Ceramic Glass – see notes above</li> </ul>

All warranty claims must be submitted with the product serial number, date of purchase, proof of purchase (if requested) and details of the specific nature of the problem.

The warranty is given only to the original consumer/purchaser only and is non-transferable. The appliance must be installed by a suitable qualified person and installed as per the requirements of the manual. Failure to comply with the Installation Requirements or Building Regulations will void your warranty. Pevex reserve the right to replace any part due to manufacturing defect that fails within the warranty period under the terms of the warranty. The unit must be used for normal domestic purposes only and in accordance with manufacturer's operation instructions.

### LIMITS OF LIABILITY

The warranty does not cover:

- \* Special, incidental or consequential damages, injury to persons or property, or any other consequential loss.
- \* Any issue caused by negligence, misuse, abuse or circumstances beyond Pevex's control.
- \* Any issue with wear and tear, modification, alteration, or servicing by anyone other than an authorized service engineer.
- \* Installation and operational related problems such as draught related issues external to the stove, inadequate venting or ventilation, excessive flue offsets, negative air pressure caused by insufficient burning of improper fuel.
- \* Damage caused to the unit while in transit.
- \* Discolouration due to over firing, damage caused by impact, damage to baffles caused by over firing and fading of surface finish on castings and the outer stove body.
- \* Stress fractures on firebricks.
- \* Rust on parts unless reported prior to unit being installed.
- \* Aesthetic damage, rust & missing parts on units purchased off display.

**Note:** Adequate clearance must be maintained around the appliance to ensure the ease of part removal in the possible event of their damage/failure. PEVEX are not responsible for any costs incurred in the removal of items installed in the vicinity of the appliance that have to be moved to facilitate a part replacement.

**SEE FULLY WARRANTY DETAILS AT THE REAR OF THIS MANUAL  
PLEASE RETAIN THIS MANUAL IN A SAFE PLACE TO REFER TO LATER**

## INSTALLATION CHECK LIST

### **Flue System**

Tick ☒

1. Minimum Flue Height of 4.6 metres (15 feet). ☐
2. Appliance should be connected to a 125mm (5") diameter flue pipe throughout ☐
3. The horizontal flue run should not exceed 150mm (6") ☐
4. All flue pipework passing through walls must be sleeved & adequately insulated in line with current Building Regulations. ☐
5. Appliance should be connected to a chimney of less than 200mm (8") in diameter (otherwise the chimney must be lined with a minimum 125mm (5") flue liner). ☐
6. The chimney/flue termination must be located in accordance with building regulations part J. ☐
7. The chimney serving this appliance should not serve any other appliance. ☐
8. Access should be provided to the chimney serving the appliance to allow for cleaning. ☐
9. It is a requirement by Building Regulations to have a carbon monoxide alarm fitted to any room with a solid fuel appliance. ☐

### **Location**

10. Clearance to combustible materials must be adhered to as described in the Clearance to Combustible section. ☐
11. The stove must be installed on a Hearth (floor protector) that covers the area under the stove and extends 460mm (18") to the front, 200mm (8") to the sides and back. ☐
12. Clearance must be maintained to allow for maintenance and part replacement. ☐

### **Ventilation & Combustion Air Requirements**

13. The room in which the appliance is located should have an air vent of adequate size to support correct combustion or an External Air Kit is fitted (see Ventilation & Combustion Air Requirement Section for specific details). ☐
14. The stove must not be installed in the same room as an extractor fan. ☐



## **IMPORTANT OPERATION / MAINTENANCE NOTES**

Now that your Brightwell Solid Fuel Stove is installed and no doubt you are looking forward to the many comforts it will provide, we would like to give you some tips on how to get the best results from your stove.

1. We would like if you could take some time to read the operating instructions/hints, which we are confident, will be of great benefit to you.
2. Do not burn fuel with a high moisture content, such as unseasoned timber, waste/pallet wood. This will only result in a build up of tar in the stove and in the flue/chimney.

**PLEASE NOTE – this Brightwell stove has been fully tested for compliance to the BS EN 13240 Standard, Eco Design 2022 Standard, and the DEFRA Smoke Exempt Standard on Wood Logs and Manufactured Smokeless Briquettes only**

**IMPORTANT:** The first few fires should be relatively small to permit the refractory fire boards and paint to set properly and season the stove. During these firings it is recommended to ventilate the room as an unpleasant (not toxic) odour and smoke may be emitted as the paint is completing curement.

**LEAVE THE DOOR SLIGHTLY AJAR (20mm) DURING THE FIRST FIRING of (20 to minutes) TO PREVENT THE ROPE FROM STICKING TO THE PAINT DURING THE CURING PROCESS.**

3. **Inspect the flue-ways of the stove weekly and ensure that there are no blockages. Check flue ways before lighting especially after a shut down period. Please see chimney cleaning section.**
4. Never allow a build up of ashes in the ash pan, as this will cause the grate to burn out prematurely. Empty the ash pan daily when in use but only when the stove is cold using the ash pan handle
5. **Avoid slow burning of damp or unseasoned fuel as this will result in tarring flue ways and chimney and potentially damaging the door glass which can cause it to craze – see below**
6. **Additionally slow burner/slumbering the stove. This can also cause crazing of the glass once the glass has been crazed it will go cloudy with lines all over the glass once this has occurred the glass needs to be replaced this is not covered by any warranty whatsoever, to help avoid this burn the fire on maximum for a minimum of 5 minutes in every 60 minutes as this help to burned off any harmful substances on the glass**
7. Allow adequate air ventilation to ensure plenty of air for combustion.
8. Do not burn rubbish/household plastic.
9. Clean the chimney at least once a year.
10. Burning soft fuels such as timber will stain the glass. Regular cleaning will prevent permanent staining. Clean with a dry wipe when cool.
11. Keep all combustible materials a safe distance away from stove, please see section for clearances to combustibles.
12. Never use or attempt to burn aerosol spray can (full or empty) near the appliance when it is in operation.
13. For safety reasons never leave children or the elderly unaccompanied while stove is in use. Use a fire guard.
14. Avoid contact with the appliance when in use as stove reaches very high operating temperatures.
15. This appliance should be regularly maintained by a competent service engineer.
16. Always use heatproof gloves to open the door for refueling and when placing logs onto the firebox

## INSTALLATION & OPERATING INSTRUCTIONS

### GENERAL

When installing, operating and maintaining your Brightwell Stove respect basic standards of fire safety. Read these instructions carefully before commencing the installation. Failure to do so may result in damage to persons and property. Consult your local Council office and your insurance representative to determine what regulations are in force. Save these instructions for future reference.

Please note that it is a legal requirement under England & Wales Building Regulations that the installation of the stove is either carried out under Local Authority Building Control approval or is installed by a Competent Person registered with a Government approved Competent Persons Scheme. HETAS Ltd operate such a scheme and a listing of their Registered Competent Persons can be found on their website at [www.hetas.co.uk](http://www.hetas.co.uk).

Special care must be taken when installing the stove such that the requirements of the Health & Safety at Work Act are met.

#### **Handling**

Adequate facilities must be available for loading, unloading and site handling. As this stove is HEAVY

#### **Fire Cement**

Some types of fire cement are caustic and should not be allowed to come into contact with the skin. In case of contact with the skin wash immediately with plenty of water.

#### **Asbestos**

This stove contains NO asbestos. If there is a possibility of disturbing any asbestos in the course of installation then please seek specialist guidance and use appropriate protective equipment.

#### **Metal Parts**

When installing or servicing this stove care should be taken to avoid the possibility of personal injury.

### **“IMPORTANT WARNING”**

This stove must not be installed into a chimney that serves any other heating appliance.

The complete installation must be done in accordance with current Standards and Local Codes. It should be noted that the requirements and these publications may be superseded during the life of this manual.

*Please refer to the current standards, BS EN 15287-1:2007 Design, Installation and Commissioning of chimneys. BS EN 14336:2004: Heating Systems in Buildings. Installation & Commissioning of Water Based Heating Systems. BS EN 12828: 2003; Heating Systems in Buildings. Design of Water Based Heating Systems. BS EN 12831: 2003; Heating Systems in Buildings. method for calculation of the design heat load.*

Your Brightwell stove is supplied with the following items:

- Rear Heat Shield – fitted to the stove
- Ashpan with Handle & Glove
- Flue Spigot for 5 inch diameter flue
- Removable Log Retainer

### FLUES

Flues should be vertical wherever possible and where a bend is necessary, it should not make an angle of more than 45° with the vertical. Horizontal flue runs should be avoided except in the case of a back outlet from the appliance, when the length of the horizontal section should not exceed 150mm.

In order to minimise flue resistance and to make sweeping easier it is recommended to use 2 x 45° bends rather than a 90° bend.

### CHIMNEY

**Do not connect to a chimney serving another appliance.**

The stove is a radiant room heater and must be connected to a chimney of the proper size and type.

The stove is designed to be installed with a 5" (125mm) flue throughout. The stove is supplied with a 5" flue spigot. It is best to connect to a chimney of the same size, as connection to a larger size may result in a somewhat less draught.

A flue that has proved to be unsatisfactory, particularly with regard to down draught should not be used for venting this appliance until it has been examined and any faults corrected. An existing masonry chimney should be inspected and if necessary repaired by a competent mason or relined using an approved lining system.

All register plates, restrictor plates, damper etc., which could obstruct the flue at a future date should be removed before connecting this appliance.



If connecting to an existing chimney with a flue diameter of more than 200mm (8") it is recommend to line the flue using a suitable stainless steel flue liner.

Where a masonry chimney is not available a proprietary type of 5"/125mm - twin wall, fully insulated pipe may be used. The pipe must terminate at a point not lower than the main ridge of adjacent out- side obstructions. With such installation, access to the chimney must be provided for cleaning purposes.

A chimney / flue termination must be located to minimise wind effects, a basic guide is that the distance from the termination to the roof should be at be at least 2300mm when measured horizontally and at least 1000mm when measured vertically, (see Fig.1). In circumstances where there are adjoining buildings/structures/roof openings there are additional requirements, please refer to building regulations part J.

Fig.1

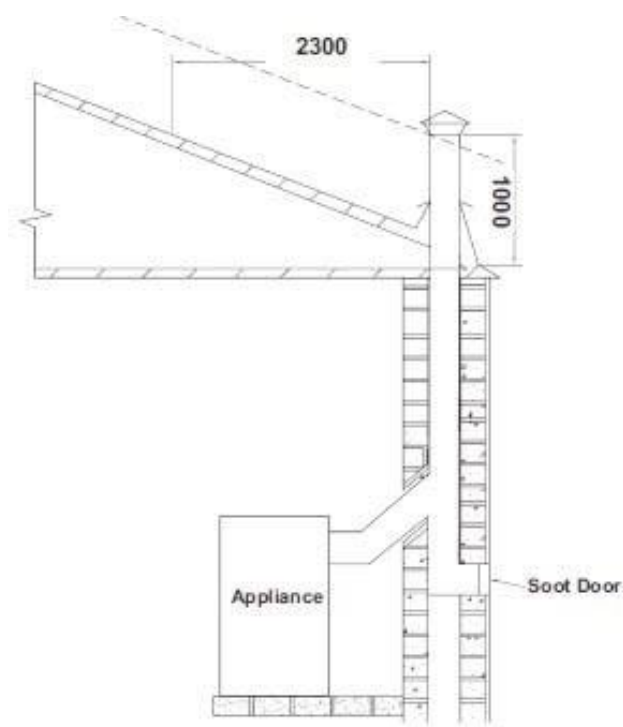

## **FLUE EXIT (TOP & REAR)**

The stove is designed to allow the chimney to be cleaned through the stove. If the chimney cannot be cleaned through the stove it is necessary to provide a soot box/access door in the flue for cleaning. See Fig.2 for recommended locations. Fit it to the stove as shown in Fig.2.

The stove comes partially configured for top outlet and requires the flue spigot (supplied in the firebox) to be fitted to the top outlet flue connection as shown in Fig 3 using the nuts & bolts provided.

To configure for back outlet flue connection, remove the top plate and remove the back heat shield by lifting it up to remove it from its four fixing points. Remove the flue blanking plate from the back outlet connection. Remove the flue collar/spigot from the top connection and fit it to the back outlet connection. Fit the flue blanking plate to the top outlet connection. Remove the cut-out on the back heat shield and refit the heat shield. Fit the top flue blanking plate (this is an optional extra) (see Fig 4).

Fig.2

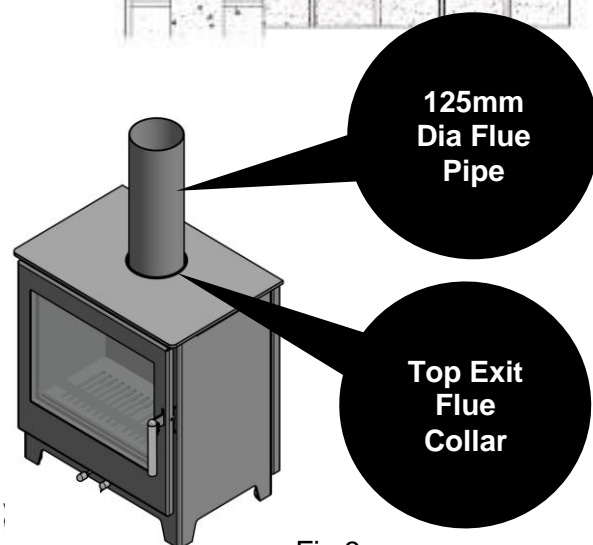
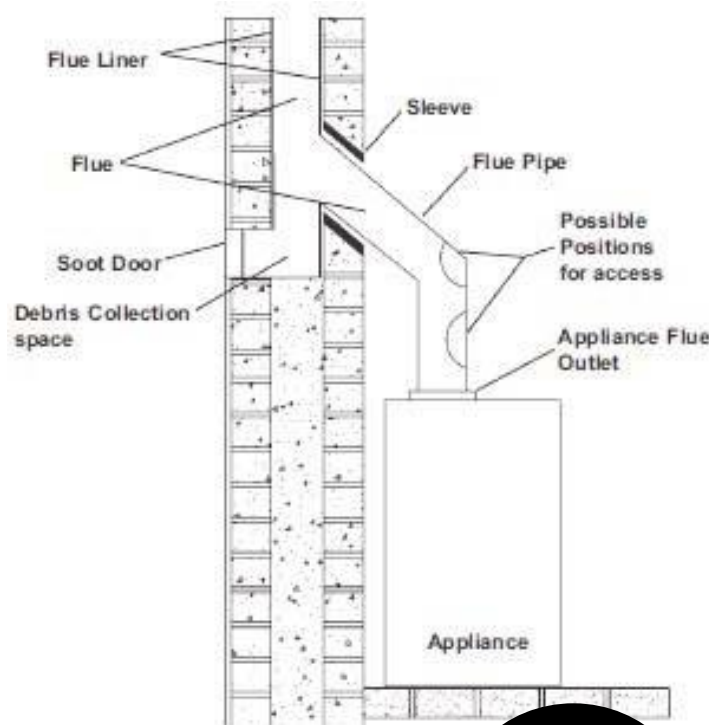
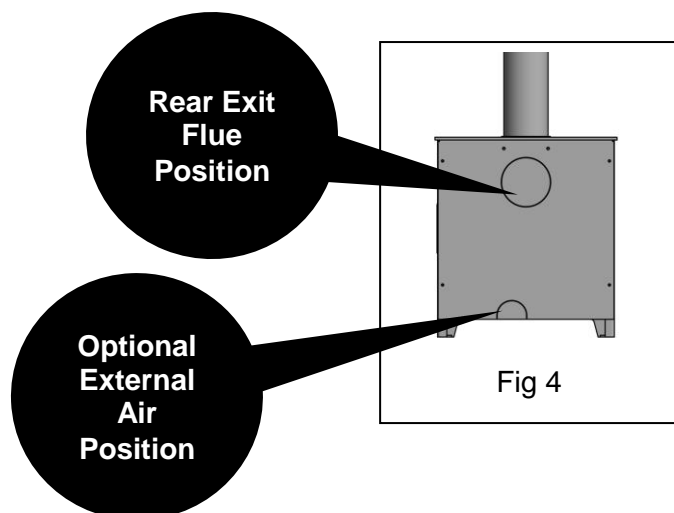
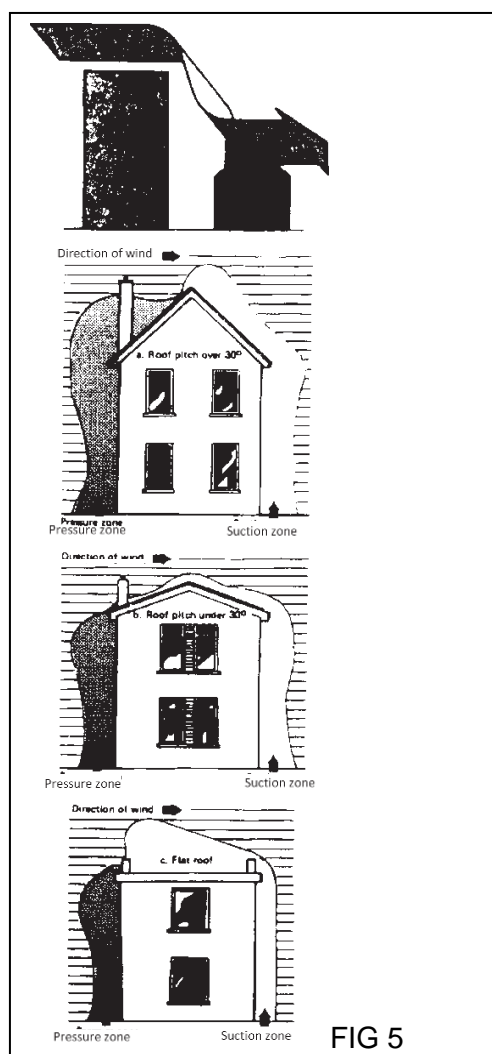

Fig 3



### DOWN DRAUGHTS

However well designed constructed and positioned, the satisfactory performance of the flue can be adversely affected by down draught caused by near-by hills, adjacent tall buildings or trees. These can deflect wind to blow directly down the flue or create a zone of low pressure over the terminal. A suitable terminal or cowl will usually effectively combat direct down blow but no cowl is likely to prevent down draught due to a low pressure zone. See Fig.5



### VENTILATION & COMBUSTION AIR REQUIREMENTS

It is imperative that there is sufficient air supply to the stove in order to support correct combustion. The air supply to this appliance must comply with current Building Regulations Part J, Heat Providing Appliances. If another appliance is fitted in an adjacent room it will be necessary to calculate an additional air supply.

The minimum effective air requirement for this appliance is 8.25cm<sup>2</sup>. When calculating combustion air requirements for this appliance use the following equation:

550mm<sup>2</sup> per each kw of rated output above 5kw should be provided, where a flue draught stabiliser is used the total free area shall be increased by 300mm<sup>2</sup> for each kw of rated output.

### NOTE:

There must not be an extractor fan fitted in the same room as the stove as this can cause the stove to emit smoke and fumes into the room.

All materials used in the manufacture of air vents should be such that the vent is dimensionally stable, corrosion resistant, and no provision for closure.

The effective free area of any vent should be ascertained before installation. The effect of any grills should be allowed for when determining the effective free area of any vent.

Air vents should be positioned so that they are not liable to blockage.

Air vents direct to the outside of the building should be located so that any air current produced will not pass through normally occupied areas of the room.

An air vent outside the building should not be located less than the dimensions specified within the Building Regulations and B.S. 8303: Part 1 from any part of any flue terminal. These air vents must also be satisfactorily fire proofed as per Building Regulations and B.S. 8303: Part 1.

Air vents in internal walls should not communicate with bedrooms, bedsits, toilets, bathrooms or rooms containing a shower.

Air vents traversing cavity walls should include a continuous duct across the cavity. The duct should be installed in such a manner as not to impair the weather resistance of the cavity.

Joints between air vents and outside walls should be sealed to prevent the ingress of moisture. Existing air vents should be of the correct size and unobstructed for the appliance in use.



If there is an extraction fan fitted in adjacent rooms where this appliance is fitted, additional air vents may be required to alleviate the possibility of spillage of products of combustion from the appliance/flue while the fan is in operation. Refer to B.S. 8303 Part 1.

Where such an installation exists, a test for spillage should be made with the fan or fans and other appliances using air in operation at full rate, (i.e. extraction fans, tumble dryers) with all external doors and windows closed.

If spillage occurs following the above operation, an additional air vent of sufficient size to prevent this occurrence should be installed.

### ***Especially Airtight Properties:-***

If the stove is being fitted in a property where the design air permeability is less than  $5\text{m}^3 / (\text{h.m}^2)$  (normally newer properties built from 2006), then a permanent ventilation must be fitted to provide  $550\text{mm}^2$  of ventilation for each kW of rated output. If a draught stabiliser is also fitted then the requirement is  $850\text{mm}^2$  per kW of rated output.

## **EXTERNAL DUCTED AIR**

An optional outside air kit which will allow for the air supply for the stove to be ducted from outside and is available to order for connection to the stove.

It is recommended to bring the air supply for the stove into the house using a 100mm diameter plastic pipe. Where the pipe meets the outside wall make sure a vent cover is fitted properly to ensure no rodents can enter via the vent pipe.

The vent pipe should be located to prevent the ingress of moisture and in a location where it will not get blocked with leaves or any other debris. As wind effects can create suction and pressure zones of opposite sides of the dwelling it is recommended to run the air vent from opposite poles (North, South, East & West) of the dwelling and tee off for the air supply to the stove. This should negate the effect of suction and pressure zones. See Fig.6

*'HETAS product approval covers this appliance when installed in accordance with the manufacturer's instructions and relevant standards. As there is currently no standard for Ducted Combustion Air Supply this does not fall within the remit for HETAS product approval. Responsibility for the specification of this and for appropriate manufacturer's instructions is carried by the appliance manufacturer, as allowed for under the Building Regulations.'*

Fig.6

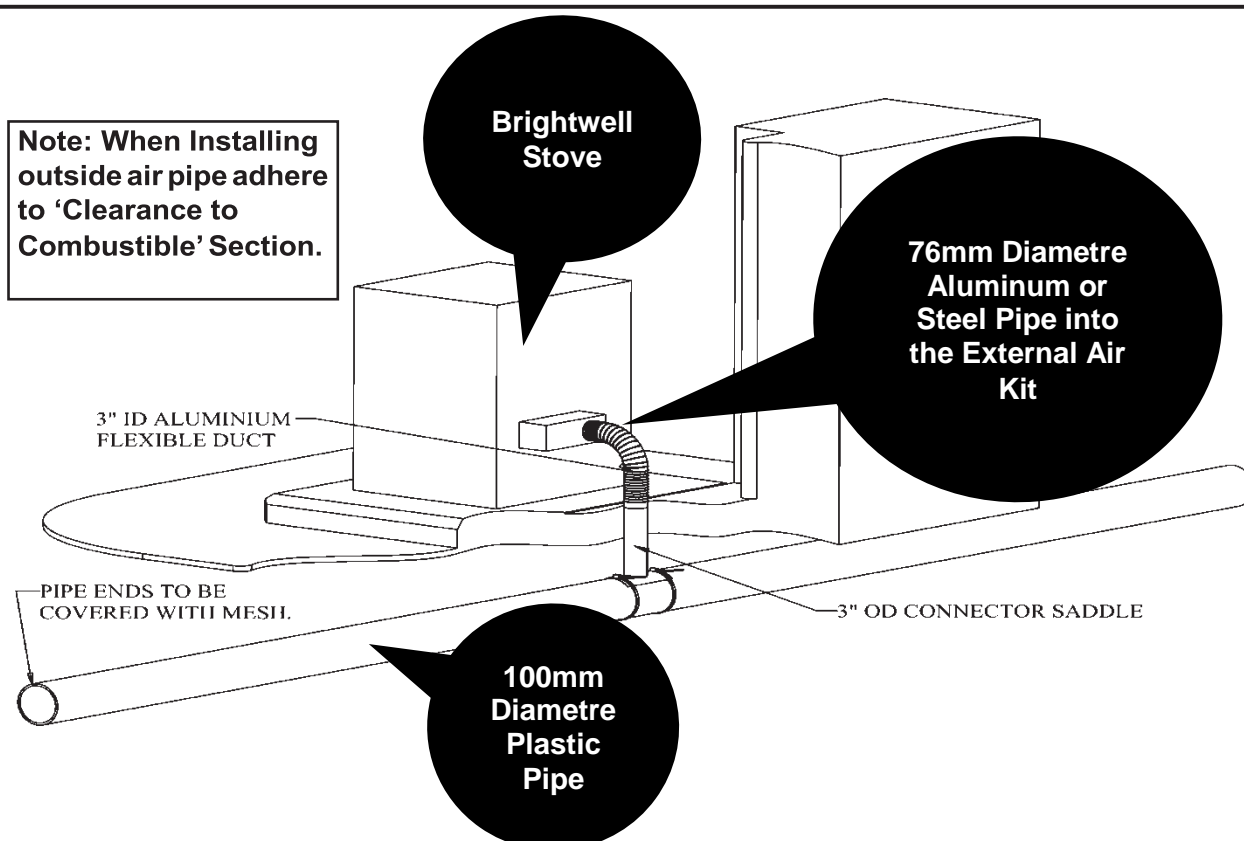

## HEAT RECOVERY VENTILATION

Where a stove is to be installed in a dwelling with *Heat Recovery Ventilation* (HRV) a number of precautionary measures must be undertaken:

Where the product is to be installed with a Mechanical Ventilation, the stove must be connected to an external air supply. The ductwork for the external air supply must be no longer than 6 metres and the air inlet terminal to the ductwork must have a cross sectional area of at least 80cm<sup>2</sup>.

## LOCATION

There are several conditions to be considered in selecting a location for your Brightwell Stove.

- Position in the area to be heated, central locations are usually best.
- Allowances for proper clearances to combustibles.
- Allowances for proper clearances for maintenance work.

## CLEARANCES TO COMBUSTIBLES

**MAINTAIN AT LEAST THE FOLLOWING CLEARANCES TO ALL COMBUSTIBLE MATERIALS:** Refer to the table below these measurement assume the stove heat output is no greater than 5.00 Kilowatts

MINIMUM DISTANCE FOR CLEARANCE TO ALL COMBUSTIBLE MATERIALS	DISTANCE IN MM
From the Front – HOT ZONE	1000mm (39")
From the Back of the stove to the wall (with rear heat shield fitted & <b>twin wall insulated flue pipe</b> - see Fig 7	200mm (8")
From the Back of the stove to the wall (with rear heat shield fitted & <b>single wall flue pipe</b> – see Fig 7	350mm (14")
From the Sides of the stove to the side wall (with rear heat shield fitted & <b>twin wall insulated flue pipe</b> – see Fig 7	500mm (20")
From the Sides of the stove to the side wall (with rear heat shield fitted & <b>single wall flue pipe</b> – see Fig 7	550mm (22")
Mantle Clearance Above the stove	Refer to Building Regs

Fig 7

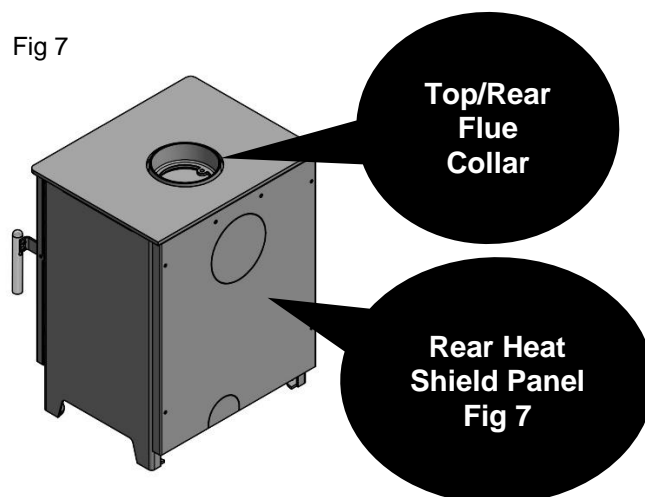

## FLOOR PROTECTION - HEARTH

When installing this heater on a combustible floor, a floor protector consisting of a layer of non combustible material at least 12mm thick is required to cover the area under the stove and extend at least 300mm at the front, 200mm to the sides & the rear. This will provide protection from sparks and embers which may fall out from the door when stoking or refuelling. See Fig.8. – Please refer to Building Regulations document J for guidance

Fig.8 – Showing Minimum Sizes of the Hearth

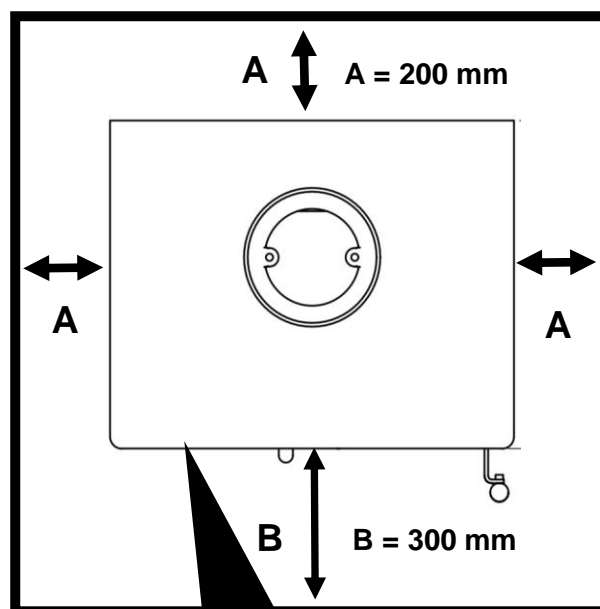

Fig 8 - Top View of the Stove

**HOT ZONE**  
TO THE FRONT OF THE  
STOVE EXTENDS OUT  
1000MM

## CLEARANCES TO NON COMBUSTIBLES

If you are fitting the stove into a brick built fireplace and it's deemed as **Non-combustible** you would still fit the **Non-combustible hearth** but you could then reduce the distance around the back and the sides of the stove to the non-combustible brick wall, we would recommend 100 mm this allows you access around the stove for servicing

**WARNING: DO NOT OBSTRUCT PRIMARY, SECONDARY OR TERTIARY AIR SUPPLY TO THE STOVE, THIS IS FED FROM THE MIDDLE REAR UNDERNEATH OF THE STOVE**

**Note:** Dimensions stated are in millimetres (mm) unless otherwise stated and may be subject to a slight +/- variation.

### COMMISSIONING AND HANDOVER

On completion of the installation allow a suitable period of time for any fire cement and mortar to dry out, when a small fire may be lit and checked to ensure the smoke and fumes are taken from the stove up the chimney and emitted safely to the atmosphere. **Do not run at full output for at least 24 hours.**

Ensure that the operating instructions for the stove are left with the customer. Ensure to advise the customer on the correct use of the appliance with the fuels likely to be used on the stove and warn them to use only the recommended fuels for the stove. Advise the user what to do should smoke or fumes be emitted from the stove.

The customer should be warned to use a fireguard to BS 8432: 2010 in the presence of children, aged and/or infirm persons.

### MAXIMUM LOADING OF FUEL ON THE FUEL BED – SEE FIG AA

### OPERATION

Check that all 2 x Air Control levers/dampers and Door catch are operating correctly and ensure that all flue connections are thoroughly sealed.

### AIR CONTROLS

The stove has two independent Air Controls:

1. **The Primary Air Control Lever** which controls the Primary Air (See Fig 10). Easily PULL out to open & push in to close
2. **The Secondary Air Control Lever** which controls the Secondary Air (air wash down the glass in the door) and the Tertiary Air for the air in the back of the stove (See Fig 10). Easily Pull out to open & push in to close

**Note:** The controls may become HOT when the stove is in operation, use the heatproof glove provided to adjust the controls when the stove is hot

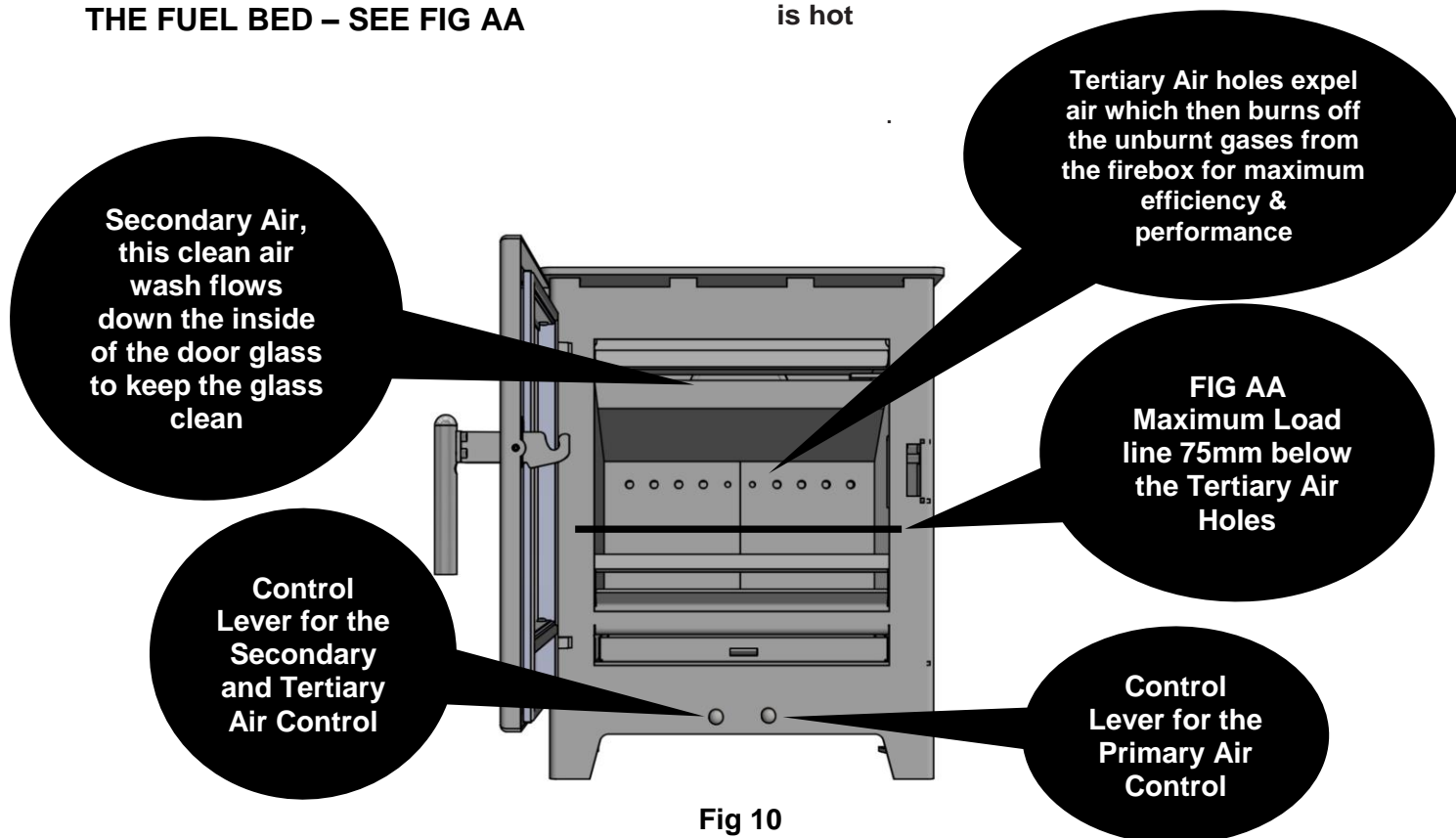

Fig 10

## RECOMMENDED FUELS

**All fuels should be stored under cover and kept as dry as possible prior to use.** This appliance has been tested using seasoned wood logs and manufactured briquetted smokeless fuel (Ancit-MSF) for closed appliances, sized between 20g and 140g. Other fuels are commercially available and may give similar results. Wood logs up to 325mm long are suitable. All fuels should be stored under cover and kept as dry as possible prior to use.

**DO NOT USE Household Coal or fuels with a Petro-coke ingredient** as this may cause the grate to overheat, causing damage and void your warranty. Reduced outputs will result when fuels of lower calorific values are used. Never use gasoline or gasoline type lantern fuel, kerosene, charcoal lighter fluid or similar liquids to start or freshen up a fire in this stove

Keep all such liquid well away from the stove at all times. Operate the stove only with the fuelling door closed except for re-fuelling.

This stove has obtained approval for burning natural and manufactured smokeless fuels only as detailed in **WARRANTY on page 26** This approval does not cover the use of other fuels either alone or mixed with the recommended fuels listed, nor does it cover instructions for the use of other fuels.

## LIGHTING

**Before lighting the stove check with the installer that the installation work and commissioning checks described previously have been carried out correctly and that the chimney has been swept clean, is sound and free from any obstructions. As part of the stoves commissioning and handover the installer should demonstrate how to operate the stove correctly.**

**LEAVE THE DOOR SLIGHTLY AJAR BY APPROXIMATELY 20MM, DURING THE FIRST FIRING TO PREVENT THE ROPE FROM STICKING TO THE PAINT DURING THE CURING PROCESS.**

TECHNICAL DATA				
	MANUFACTURED SMOKELESS FUEL (MSF)		WOOD	
	Room	Total	Room	Total
Max Output: (kW)	6.5	6.5	6.5	6.5
Nominal Output: (kW)	4.9	4.9	5.0	5.0
Typical refuelling intervals to obtain nominal outputs:	MSF 1 hr		WOOD .85 hr	
CO@ 13% oxygen:	0.05%		0.11%	
Flue Gas Temperature at nominal output:	270°C		230°C	
Gross Weight Approximate:	80 Kgs			
Flue Outlet Diameter:	125mm			
Flue Draught:	12 Pa			
Efficiency:	81.5 %		84.8%	
Log Size:	N/A		325mm	
Flue Gas Mass Flow: (g/s)	3.6		3.6	
Energy Efficiency Rating:	N/A		A+	
Mean C <sub>n</sub> H <sub>m</sub> (at 13 % O <sub>2</sub> ) Nmg/m <sup>3</sup>	13		109	
Mean NO <sub>x</sub> (at 13 % O <sub>2</sub> ) Nmg/m <sup>3</sup>	91		92	
DIN Plus dust (at 13 % O <sub>2</sub> )s Nmg/m <sup>3</sup>	21		25	

## LIGHTING THE STOVE

When operating the stove, it is recommended to use the Heatproof Glove provided to open the fire door as the door handle will become hot.

1. Open the fire door and open the primary air control by pulling it fully out.
2. Open the secondary air inlet by pulling the control fully out.
3. Cover the grate with crumpled pieces of paper and lay 10-12 pieces of kindling on top of the paper towards the back of the firebox.
4. Ignite and close the fire door.
5. When the kindling is well alight open the fire door and add more kindling of a larger size to sustain the fire. Close the fire door.
6. When a hot fire bed is established add the normal fuel.
7. When well lighted, adjust the air controls as required depending on the fuel type being used & the heat output required (see Table below). Both controls should be adjusted in conjunction with each other to get the appropriate burn rate with exact settings on each control depending on the draught conditions of the chimney to which the unit is connected.

Fuel	Primary Air	Secondary Air
Smokeless Fuel	Adjust to Desired Setting	Fully Closed
Wood	Max Opening of 50%	Adjust to Desired Setting

**WARNING: DO NOT LEAVE BOTH AIR CONTROLS FULLY OPEN AS THIS CAN CAUSE THE STOVE TO OVERHEAT, DAMAGING THE INTERNAL COMPONENTS.**

## REFUELLING

Before opening the door, open the primary air control fully as this will help to eliminate any smoke or fly ash resident in the combustion chamber. Add fuel to fire, close fire door and adjust the primary air control to the desired position

## BURNING SMOKELESS FUELS

When loading the fire with smokeless fuels it is advised not to put all the required fuel in at once, load in two stages to ensure that the fire will not be smothered and wait between each stage for the flames to grow before adding the remaining fuel. Certain fuels may produce more soot deposits than others, therefore it is essential for you to regularly clean the baffle/throat plates to avoid build up. When relighting a smokeless fuel fire ensure you have cleared the grate and emptied the ash pan before starting a new fire.

## SLOW BURNING

Slow burning will cause the window glass to blacken and can craze the glass this should not be used for a long period. It should only be done after the fire has been established and been running at nominal output for a period of time. For a prolonged slow burn, fill the firebox of fuel up to a maximum load level which is 75mm below the Tertiary air holes on the back fire boards (refer to Fig 10). Push the primary air control knob in to close the primary air to the minimum setting and push the secondary air control in to set the secondary air to the minimum setting. Please refer to Page 11 items 5 & 6

## DISPOSAL OF ASHES

Your stove is provided with an ashpan. This ashpan should be emptied every day.

If ashes are allowed to build to grate level you could damage the grate by overheating. We recommend that you remove ashes after you have riddled the fire when the stove is thoroughly cooled.

Ashes should be placed in a metal or other non-combustible container with a tight fitting lid. The closed container of ashes should be placed on a non-combustible material, pending final disposal. If ashes are buried in soil, or otherwise dumped they should be retained in the closed container until they are thoroughly cooled.

Open the fire door and remove the ash pan using the tool provided, see Fig 11. Close the fire door. When the ash is disposed of replace the ash pan.

Fig 11





## MONTHLY MAINTENANCE

### *Cleaning Stove Flue Pathways*

It is recommended that the flue pathways in the stove are cleaned on a regular basis (every 3 months) (or less depending on the soot build-up created by the fuel being used) and the chimney cleaned annually. To access the chimney pathways, please follow the procedure overleaf for removing and replacing the fireboards

## GLASS REPLACEMENT

Open the door fully

**1** Remove the 4 x fixing screws in the inner glass frame - refer to Fig A below

**2** Clean the glass recess in the door and remove any debris

**3** Replace the adhesive thermal tape on the back face of the door if damaged

**4** Fit the glass in position and replace the four screws

**5** Hand tighten the screws turning back quarter of a turn when they are hand tight

**6** Only use genuine parts only replace with high temperature ceramic glass

Before re-lighting the stove remove all fingerprints otherwise they will be burnt into the glass

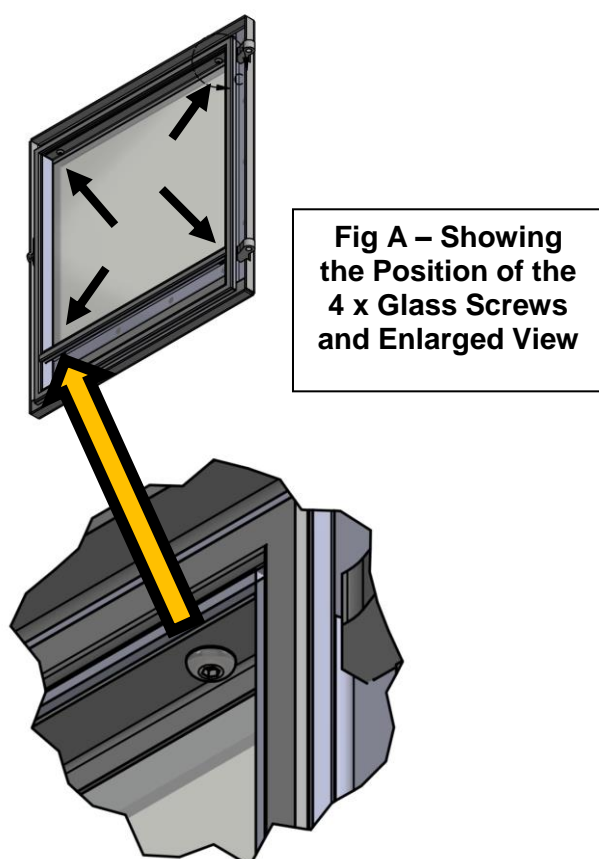

## PERIODIC MAINTENANCE

### *Adjusting the Door Catch (if required)*

Over time, the fire door latch can loosen due to the continual compression and hardening of the rope seal between the door and the front of the stove. The tightness of the door seal should be checked periodically and it is recommended that the rope seals on the stove are changed at least every two years or sooner if the seal loses its integrity.

## CHIMNEY CLEANING

The chimney should be cleaned twice annually or if the stove is not used for a prolonged period during the summer period, it should be cleaned prior to commencement of usage. The chimney can be cleaned through the stove depending on the flue configuration and the flue liner should be cleaned in accordance with manufacturer's instructions. Always use a brush with plastic bristles that is the correct size to reach all areas of the flue.

## GLASS CLEANING

The stove glass will self-clean when there is sufficient heat generated by the burning fuel i.e. when the unit is operated at the maximum air settings. If a build-up of creosote occurs on the glass it may be due to low draft conditions, poor quality fuel or operating the stove at the minimum air settings for long periods of time. The glass should be cleaned when cool and cleaned with a non-abrasive cloth or using a dry wipe. For stubborn deposits, a grade 0 steel wool can be used whilst taking care not to scratch the glass with any coal/ash deposits.

## CLEANING A MATT BLACK/ SENOTHERM STOVE

Cleaning should be done when the stove is cold by removing any dust or dirt using a dry cloth. Do not use any water on the heat proof matt black finish as this will cause it to rust.

## PROLONGED PERIODS OF NON USE

If the stove is to be left unused for a prolonged period of time then it should be given a thorough clean to remove ash and unburned fuel residues. To enable a good flow of air through the appliance to reduce condensation and subsequent damage, leave the air controls fully open.

It is important that the flue connection, any appliance baffles or throat plates and the chimney are swept prior to lighting up after a prolonged shutdown period.

## FIREBOARD REMOVAL & REPLACEMENT

### FIRE BRICK REMOVAL PROCEDURE:

Firstly open the door and remove the log retainer from the front of the firebox

**1 & 2** Lift up the front of the (1) bottom baffle (30mm thick fireboard) to allow the two side firebricks (2) to drop into the firebox & be removed (see Fig 12).

Angle the bottom baffle (1) up on the RHS to allow the LH edge of the baffle to drop into the firebox, allowing for its removal.

**3 Top Baffle Fire Board** - Lift the back of the top baffle fire boards upwards out of the saddle it sets in, whilst pushing it back to allow the front edge to drop into the firebox (see Fig 13).

**4 Top Baffle Fire Board** - When refitting the Top Baffle Fire Board make sure this board is pulled to the tight to the front to seal into the holder

Replace the components in reverse order when cleaning is complete, ensuring that the long face of the top baffle is facing downwards when fitted.

**5 Rear Fire Boards** – to remove these 2 boards pull hard from the top of each board as they are held in place with heatproof silicon which seal the tertiary air holes against the stove back plate. When refitting again reseal around all of the air holes to prevent air leakage between the rear fire board and back of the stove

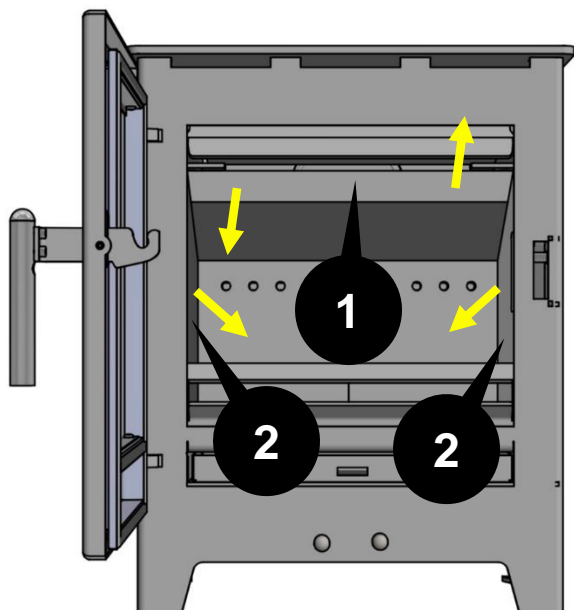

Fig 12 - Firebox

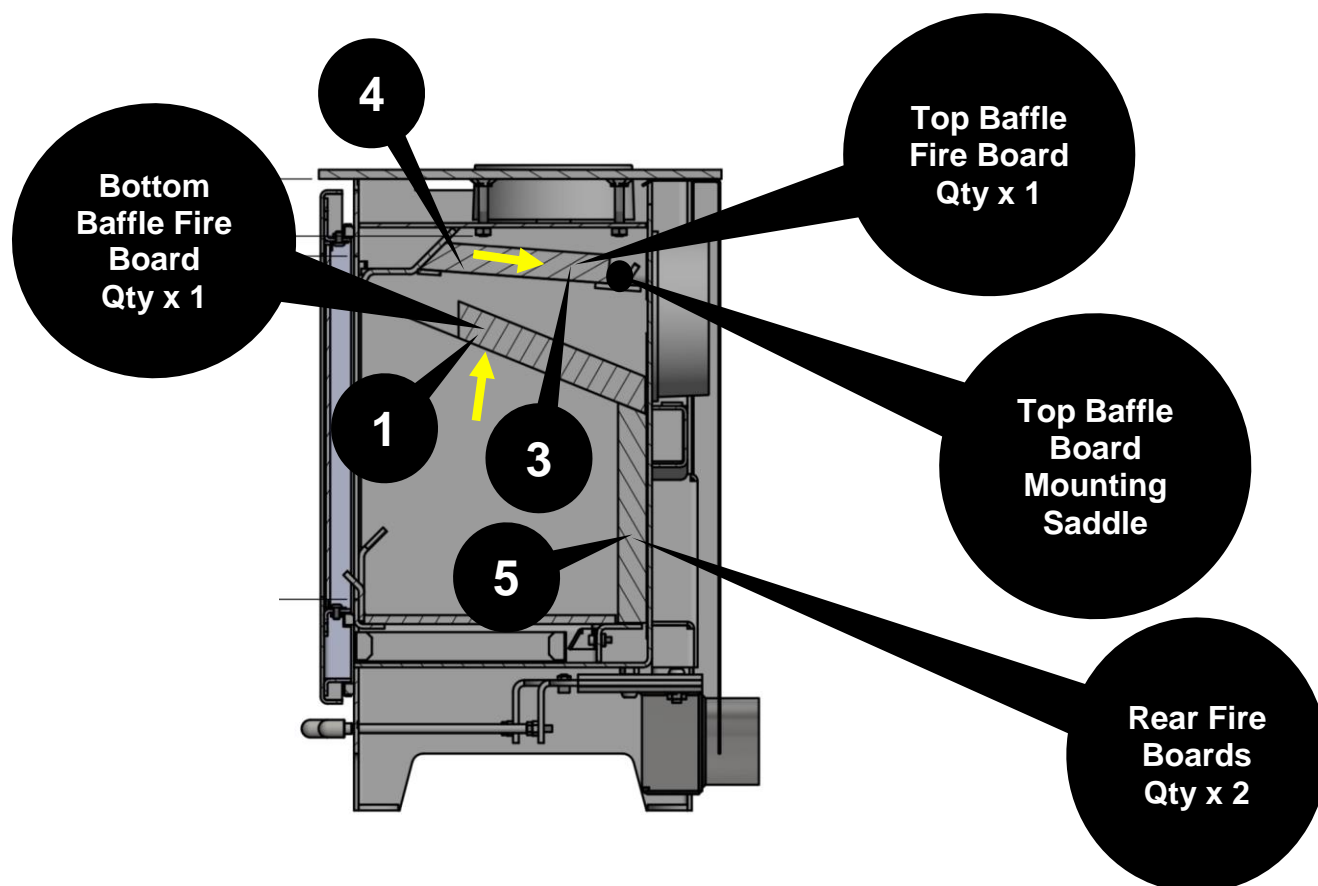

Fig 13 Section of the Firebox Showing the Inside view of the stove



### **WARNING NOTE:**

Properly installed, operated and maintained this stove will not emit fumes into the dwelling. Occasional fumes from the de-ashing and re-fuelling may occur. However, persistent fume emission is potentially dangerous and must not be tolerated. If fume emission does persist, then the following immediate action should be taken:

- (a) Open doors and windows to ventilate room.
- (b) Let the fire out or eject and safely dispose of fuel from the stove.
- (c) Check for flue or chimney blockage and clean if required.
- (d) Do not attempt to relight the fire until the cause of the fume emission has been identified and corrected. If necessary seek expert advice.

The most common cause of fume emission is flue-way or chimney blockage. For your own safety these must be kept clean at all times.

### **CARBON MONOXIDE CO ALARM**

**This is not supplied with your stove you would purchase this separately,**

**The fitting of CO Alarms in the same room as the appliance is a compulsory requirement under current Building Regulations. For ROI an additional CO Alarm must be fitted either inside each bedroom or within 5 metres of the bedroom door, refer to Building Regulations Part J. Further guidance on the installation of a carbon monoxide alarm is available in BS EN 50292:2002 and from the alarm manufacturers instructions.**

### **FIRE SAFETY**

To provide reasonable fire safety, the following should be given serious consideration.

1. Do not over fire the stove.
2. Over-firing will also damage the painted finish.
3. Install a smoke detector in the room.
4. A conveniently located Class A fire extinguisher to contend with small fires resulting from burning embers.
5. A practical evacuation plan.
6. A plan to deal with a chimney fire as follows:-
  - (a) Notify the fire department.
  - (b) Prepare occupants for immediate evacuation.
  - (c) Close all openings into the stove.
  - (d) While awaiting the fire department watch for ignition to adjacent combustibles from over-heated flue pipe or from embers or sparks from the chimney.

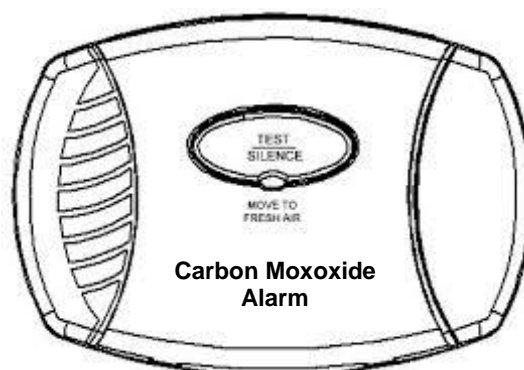

**Picturing Showing a Typical CO Alarm**

**Provision of an alarm must not be considered a substitute for either installing the appliance correctly or ensuring regular servicing and maintenance of the appliance and chimney system.**

### **WARNING**

We would also recommend the installation of a smoke detector in the room that the stove is installed in.

#### **WARNING:-**

**If the CO Alarm sounds unexpectedly:-**

- 1. Open Doors and windows to ventilate the room and then leave the premises.**
- 2. Let the fire go out.**

## EXPLODED VIEW & PARTS LIST

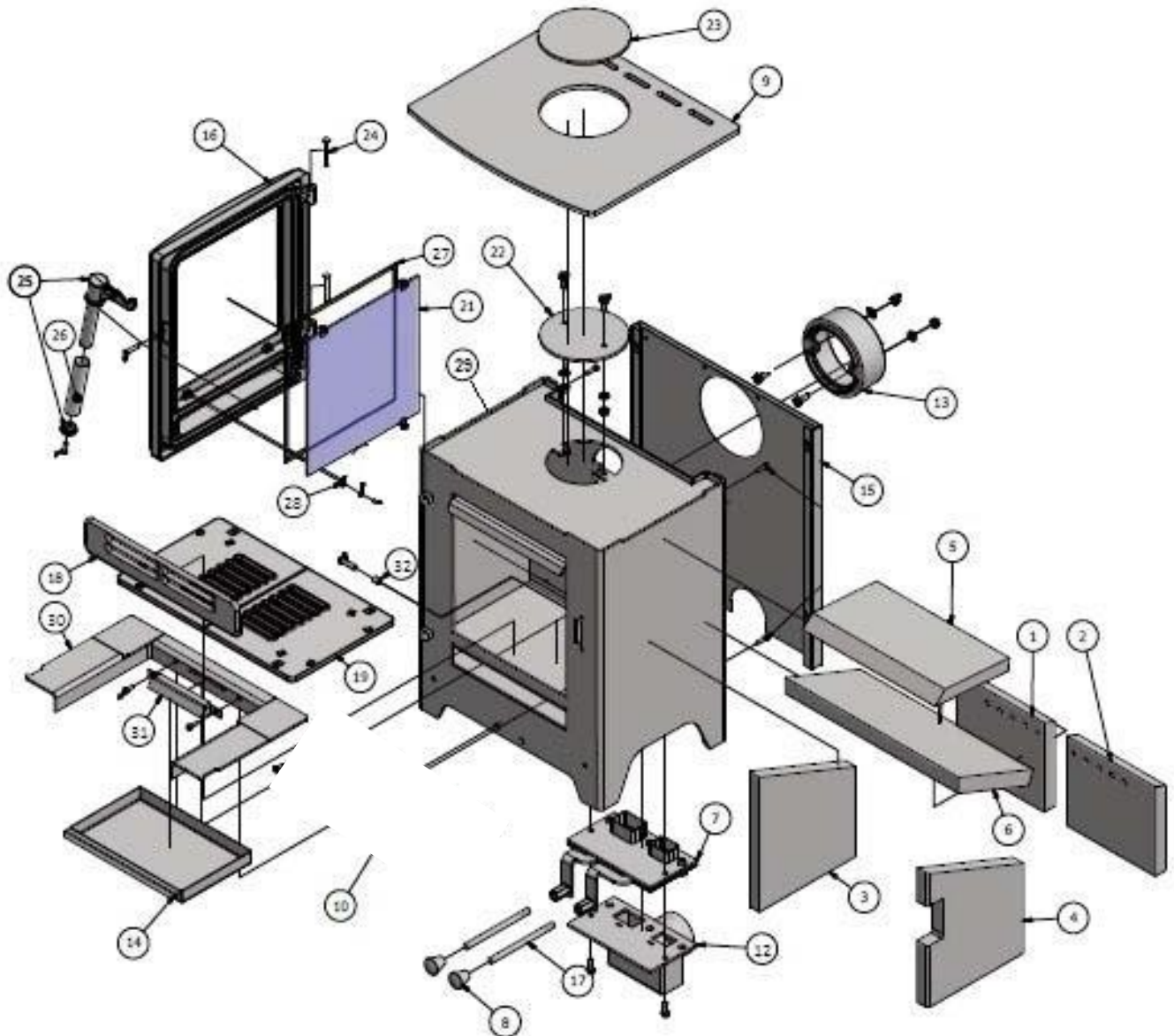

### PARTS LISTING & PART NUMBERS

- |   |  |
|---|--|
| 1. LH BACK REFRACTORY BRICK – BW/400/001    | 21. DOOR GLASS - BW/400/018                  |
| 2. RH BACK REFRACTORY BRICK - BW/400/002    | 22. FLUE BLANKING PLATE - BW/400/019         |
| 3. LHS REFRACTORY BRICK - BW/400/003        | 23. TOP PLATE FILLER - BW/400/020 - OPTIONAL |
| 4. RHS REFRACTORY BRICK BW/400/004          | 24. HINGE PIN - BW/400/021                   |
| 5. TOP BAFFLE BW/400/005                    | 25. HANDLE ASSEMBLY - BW/400/022             |
| 6. BOTTOM BAFFLE - BW/400/006               | 26. SS HANDLE SLEEVE - BW/400/023            |
| 7. AIR INLET ASSEMBLY - BW/400/007          | 27. GLASS GASKET - BW/400/024                |
| 8. CONTROL KNOB - BW/400/008                | 28. GLASS SCREWS - BW/400/025                |
| 9. TOP PLATE - BW/400/009                   | 29. MAIN BODY - BW/400/026                   |
| 10. N/A                                     | 30. GRATE FRAME - BW/400/027                 |
| 12. OUTSIDE AIR KIT - BW/400/010 - OPTIONAL | 31. PRIMARY AIR INLET COVER - BW/400/028     |
| 13. FLUE SPIGOT - BW/400/011                | 32. LOCK ROLLER - BW/400/029                 |
| 14. ASHPAN - BW/400/012                     | 33. ASH PAN HANDLE – BW/400/030              |
| 15. REAR HEATSHIELD BW/400/013              | 34. DEFRA SCREW KIT - BW/400/031             |
| 16. FIRE DOOR – BW/400/014                  |  |
| 17. AIR CONTROL ROD - BW/400/015            |  |
| 18. LOG RETAINER - BW/400/016               |  |
| 19. GRATE - BW/400/017                      |  |

## APPENDIX 1 - ANNUAL SERVICING RECORDS

For your warranty to be valid you must have this stove serviced once a year by a Competent Engineer who is qualified to service Multi-fuel stoves, please record the details here and attach your invoice as proof of service

Annual Service Record – Year 1	Annual Service Record – Year 2	Annual Service Record – Year 3
Name of Engineer who completed the service	Name of Engineer who completed the service	Name of Engineer who completed the service
Telephone & Email Contact Details	Telephone & Email Contact Details	Telephone & Email Contact Details
Engineers HETAS Registration Number (if applicable)	Engineers HETAS Registration Number (if applicable)	Engineers HETAS Registration Number (if applicable)
Date of Service	Date of Service	Date of Service
Cost of Service	Cost of Service	Cost of Service
Door & Glass Seal Replaced <b>YES or NO</b> – please circle which one	Door & Glass Seal Replaced <b>YES or NO</b> – please circle which one	Door & Glass Seal Replaced <b>YES or NO</b> – please circle which one
Other Notes	Other Notes	Other Notes
<b>Chimney Swept</b> Y / N <b>Fireboard Changed</b> Y / N <b>Top Baffle board fitted in correct position</b> Y / N	<b>Chimney Swept</b> Y / N <b>Fireboard Changed</b> Y / N <b>Top Baffle board fitted in correct position</b> Y / N	<b>Chimney Swept</b> Y / N <b>Fireboard Changed</b> Y / N <b>Top Baffle board fitted in correct position</b> Y / N

Annual Service Record – Year 4	Annual Service Record – Year 5	Annual Service Record – Year 6
Name of Engineer who completed the service	Name of Engineer who completed the service	Name of Engineer who completed the service
Telephone & Email Contact Details	Telephone & Email Contact Details	Telephone & Email Contact Details
Engineers HETAS Registration Number (if applicable)	Engineers HETAS Registration Number (if applicable)	Engineers HETAS Registration Number (if applicable)
Date of Service	Date of Service	Date of Service
Cost of Service	Cost of Service	Cost of Service
Door & Glass Seal Replaced <b>YES or NO</b> – please circle which one	Door & Glass Seal Replaced <b>YES or NO</b> – please circle which one	Door & Glass Seal Replaced <b>YES or NO</b> – please circle which one
Other Notes	Other Notes	Other Notes
<b>Chimney Swept</b> Y / N <b>Fireboard Changed</b> Y / N <b>Top Baffle board fitted in correct position</b> Y / N	<b>Chimney Swept</b> Y / N <b>Fireboard Changed</b> Y / N <b>Top Baffle board fitted in correct position</b> Y / N	<b>Chimney Swept</b> Y / N <b>Fireboard Changed</b> Y / N <b>Top Baffle board fitted in correct position</b> Y / N

## **BRIGHTWELL 400 P MULTI-FUEL STOVE – 5 YEAR WARRANTY**

It's important to know what requirements need to be met in order to qualify for our 5 year warranty, as well as being aware of exactly what it covers. This warranty only applies to our stoves.

If you have purchased your stove from an authorised stockist within our Premium Retailer Network, then automatically your product will carry a 5 year warranty. The start date for the warranty period is the date of purchase. You do not need to register your stove for the warranty to apply, but you must retain your proof of purchase from the retailer, which must have your name, address and the date of the purchase. Then from the serial number on your stove we can then action your warranty, you must have the stove serviced every 12 months and keep the service receipt for the warranty to be valid. Any product purchased outside of our Premium Retailer Network will carry a standard 12 month, non-extendable warranty.

It is a condition of the Warranty that the installation complies with relevant Building Regulations and the rules in force, and is carried out by a suitably trained and qualified individual HETAS registered in the United Kingdom (or equivalent in other countries) with a certificate of installation and the appropriate commissioning report completed and retained by the end-user. Please refer to **Appendix 1 - Annual Servicing Records**

It is also a condition of the Warranty that your Stove is regularly serviced (every 12 months) by a suitably trained and qualified individual, ideally HETAS registered in the United Kingdom (or equivalent in other countries). Records and receipts of annual services will be required in the event of a warranty claim during the period of the warranty. Please refer to **Appendix 1 - Annual Servicing Records**

This warranty is not transferable, and solely for, the benefit of the original purchaser of the stove. Please retain your dated sales receipt as a proof of purchase.

During your warranty period, only genuine spare parts must be used in the servicing and maintenance of your stove, these spare parts can be ordered via the Premium Retailer directly.

Consumable items such as glass, paint, grate parts, log retainers, ceramic fire boards (internal linings), and rope seals which are either subject to normal wear and tear or parts that require replacement in connection with normal maintenance are not covered, either by the Warranty. The Flue system is not covered by any warranty from Pevex Stoves.

Should you experience problems with your stove, any claim must be submitted first to the Premium Retailer from where the stove was purchased. Your Premium Retailer will either be able to offer immediate assistance or make contact with Pevex Stoves on your behalf.

### **Warranty Exclusions and Limitations**

No Warranty is extended to consumable service parts. Repair or replacement of parts which are subject to normal wear and tear during the warranty period or parts that will require replacement in connection with normal maintenance. Such parts include but are not limited to glass, paint, rope seals, grate parts, log retainers, and internal linings.

### **Your Stove Warranty does not cover:**

- a) In normal usage the paint finish of your Stove may change colour slightly. As these circumstances are considered normal, they are not covered by the warranty. The stove paint must be cured as detailed in this manual
- b) Enamelled components where these parts are subjected to abnormally high temperatures, chemical abrasion or thermal shocks, resulting in chipping, cracking, bubbling or discolouration and crazing of the enamelled finish.
- c) Damage resulting from installation and usage where the appliance has not been installed or used in accordance with this installation and operation instructions, or if the installation does not conform to local building, fire and safety regulations. This includes the entire flue system whether purchased from Pevex or not
- d) Defects or faults caused by specific local conditions such as draught problems, water damage, condensation and chimney defects.

- e) The Warranty does not cover damage caused by over-firing of the appliance. (Please see your Installation and Operating Instructions for further information)
- f) The entire flue system
- g) Misuse of the stove including water/liquid/heat damage
- h) Damage caused by unauthorised modifications, use or repair.
- i) Damage or defects caused by the product being stored in a damp, unheated environment.
- j) Consequential loss (to the extent permitted by law) relating to other associated products that have not been supplied by Pevex Stoves.
- k) Consequential loss (to the extent permitted by law) related to decorations, furnishings or other household assets.
- l) Delivery to/or return transport costs. Removal and re-installation costs, or any labour cost to fit parts

Repaired or replaced products are covered only for the remainder of the original warranty period. If you should ever wish to make a warranty claim because of a product fault or defect, you must inform your retailer within a reasonable amount of time, this is within 14 days from the date on which the fault or defect first became apparent. If the product fault or defect is notified after 14 days from the date on which the fault or defect became apparent, Pevex Stoves cannot accept any liability for events or issues which arise after the 14 day period or which are caused or increased by the lack of notification which therefore prevented action being taken to restrict or eliminate any consequences arising from the fault or defect at an earlier date.

In the event of a product fault occurring during the warranty period, Pevex Stoves will send the appropriate component or goods necessary to rectify the fault, free of charge, but does not cover any labour cost to fit them.

Nothing in the Warranty shall make Pevex Stoves liable for any or special, incidental or consequential damages, injury to persons or property, or any other consequential loss beyond the consumer's statutory rights. The liability on these issues is covered by Pevex Stoves Terms and Conditions of Sale.

Pevex Stoves' total liability extends only to the purchase price paid for the goods by the Premium Retailer,

The Pevex Stoves Warranty does not affect your statutory rights.

The above warranty terms and conditions came into effect on 1st January 2013 and are applicable for all relevant products purchased after this date.

**Please note:** This warranty is applicable for purchases within the United Kingdom and the Republic of Ireland

**APPROVED SMOKELESS FUELS (SOLID MINERAL FUELS) ONLY TO BE USED ON THIS STOVE**

Only the following smokeless fuels may be used in this stove, Ancit, Anthracite Large Nuts, Centurion, Extracite, Homefire, Maxibrite & Phurnacite

**Only smokeless fuels may be burnt in SMOKE CONTROL AREAS.**

**PETROLEUM COKE AND HOUSE COAL ARE NOT SUITABLE OR USE ON THIS APPLIANCE, IF USED WILL VOID YOUR WARRANTY - USE OF PETROLEUM COKE, LIQUID FUELS, HOUSE COAL AND UNAUTHORISED FUELS WILL INVALIDATE THE GUARANTEE AND MUST NOT BE USED, THESE INCLUDE EXCEL, TAYBRIGHT & BRAZIERAS** this will cause the stove to "over fire" as well as damaging the internal components. Operating at temperatures in excess of 500°C will cause irreparable damage which is not covered by the guarantee. Burning any "contaminated" or treated wood which may have been painted, varnished, oiled/stained or materials such as MDF or plywood which contain resins/glues should never be used as this will cause an over-fire situation resulting in damage to the glass and bricks not to mention the toxic gases emitted into the atmosphere. Also, never burn bituminous house coal which is designed for open fires and not for use in stoves as this fuel is very volatile and gaseous containing lots of sulphur which will **permanently etch marks in the glass** as well as potential damage to the bricks, baffles and grate





ENERGY EFFICIENCY LABEL – UNITED KINGDOM

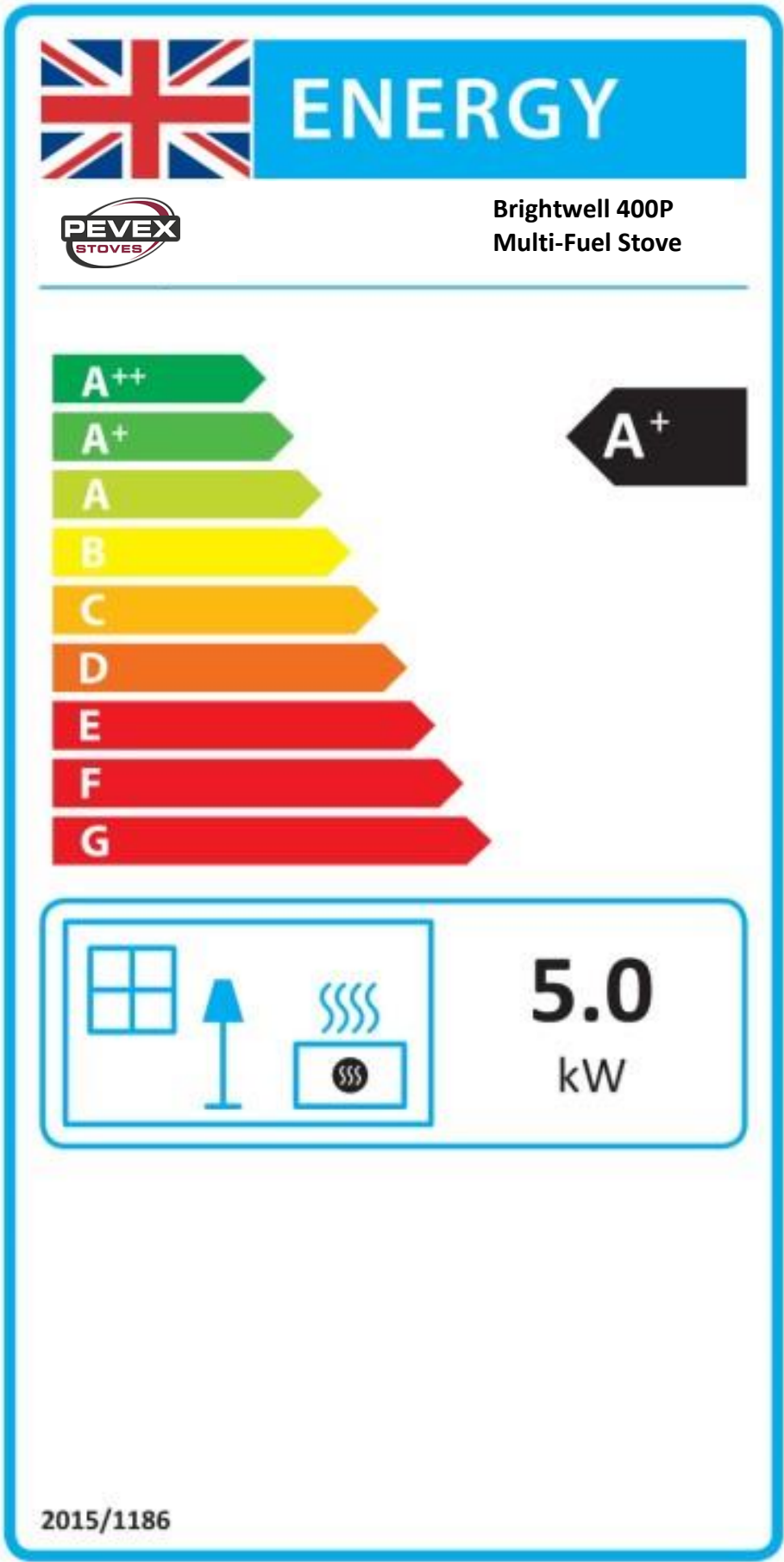

This Stove has passed the Efficiency Category A+

Official Efficiency Rating:	Manufactured Smokeless Fuel is 81.5 %	Wood is 84.8%
-----------------------------	---------------------------------------	---------------

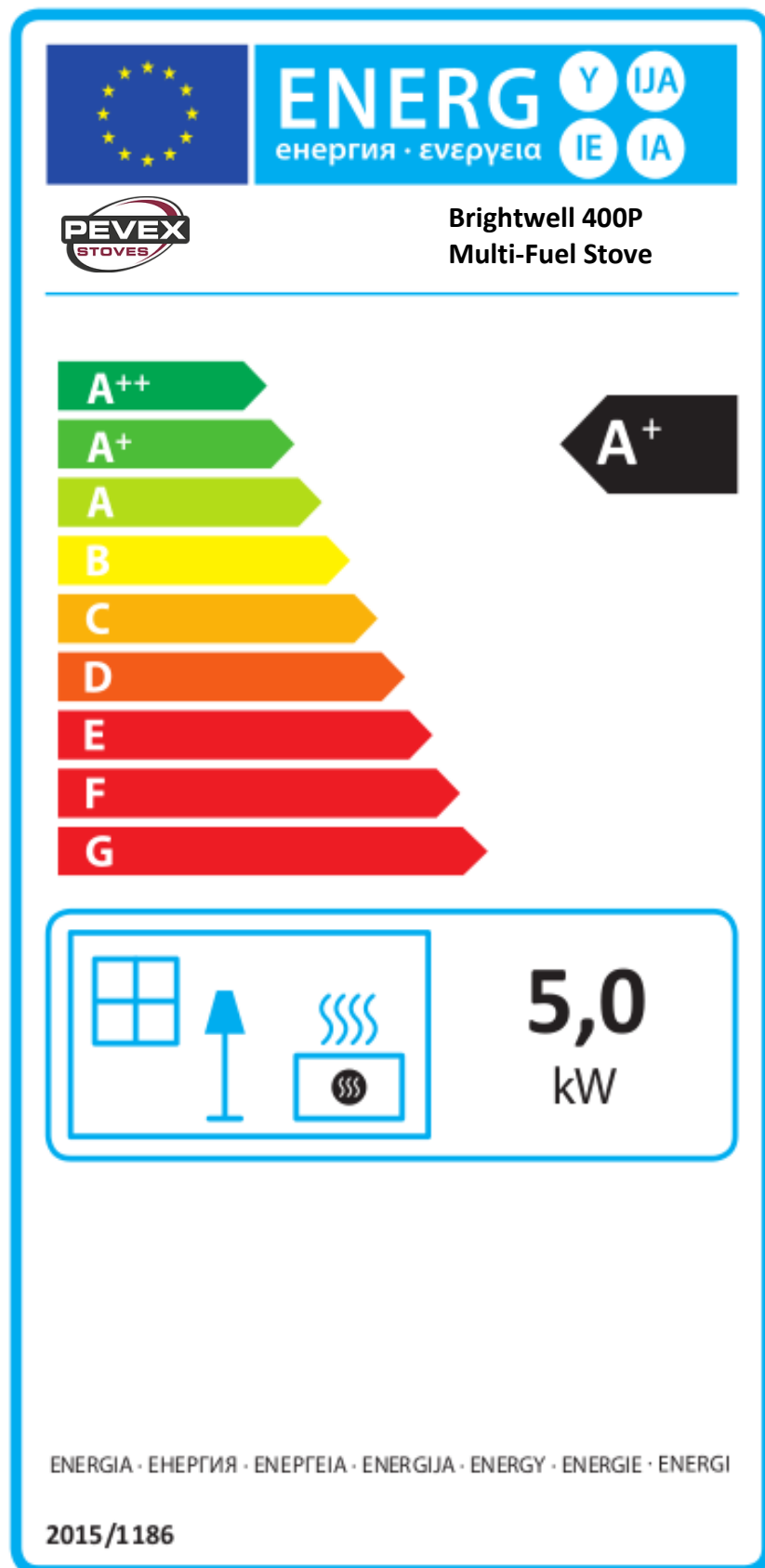

Unit MP7  
Kirrawah Business Park  
Newbourne Road  
Waldringfield  
Near Woodbridge  
IP12 4PR

Tel: (+44) 01473 736399  
Fax: 01473 736406  
sales @ pevexstoves.co.uk  
www.phevexstoves.co.uk



This Stove is fully  
Manufactured in the UK

Approved to the  
Eco Design 2022 Standard &  
BS EN 13240



*Pe vex Enterprises Limited, which trades  
as Pe vex Stoves has a policy of  
continuous product improvement and  
development,*

*Pe vex reserves the right to change  
specifications and make modifications to  
the appliance described and illustrated at  
any time*