

Operating Instructions

Woodbridge 5 Woodburning Stove



Please Note:

Stove & flue installations must be completed by a member of the Competent Persons Scheme (CPS). For example, a Hetas or Oftec certified individual. Alternatively this must be inspected and signed off by the local building control officer.

A carbon monoxide alarm must be fitted in a suitable location as part of the installation. Instructions on operation, fuel and maintenance should be provided to the home owner by the installer at the point of installation.

Please keep this document for the full duration of the warranty period. It is recommended to retain this document for general references to the operations and maintenance of the appliance.

Thank you for purchasing your Pevex Woodbridge 5 stove, developed with efficiency and easy of use in mind. These instructions should help to ensure that your stove maintains its efficient burn which has seen it gain Defra approval for use in smoke controlled areas.

CONTENTS

| | |
|---------------------------|----|
| Stove Details | 3 |
| Operating Instructions | 4 |
| Controls | 6 |
| Smoke Control Areas | 8 |
| Troubleshooting | 9 |
| Maintenance & Servicing | 10 |
| Installation Instructions | 12 |
| Warranty Information | 15 |

Product Fiche

| | |
|------------------------------|---|
| Model | Woodbridge 5 |
| Energy Efficiency Class | A+ |
| Nominal Heat Output | 5kW |
| Output Range | 2-8kW |
| Energy Efficiency Index | 112 |
| Efficiency At Nominal Output | 83.8% |
| Safety Precautions | The unit must be assembled, installed & maintained in accordance with the manufacturers operating manual. |

STOVE DETAILS

Dimensions

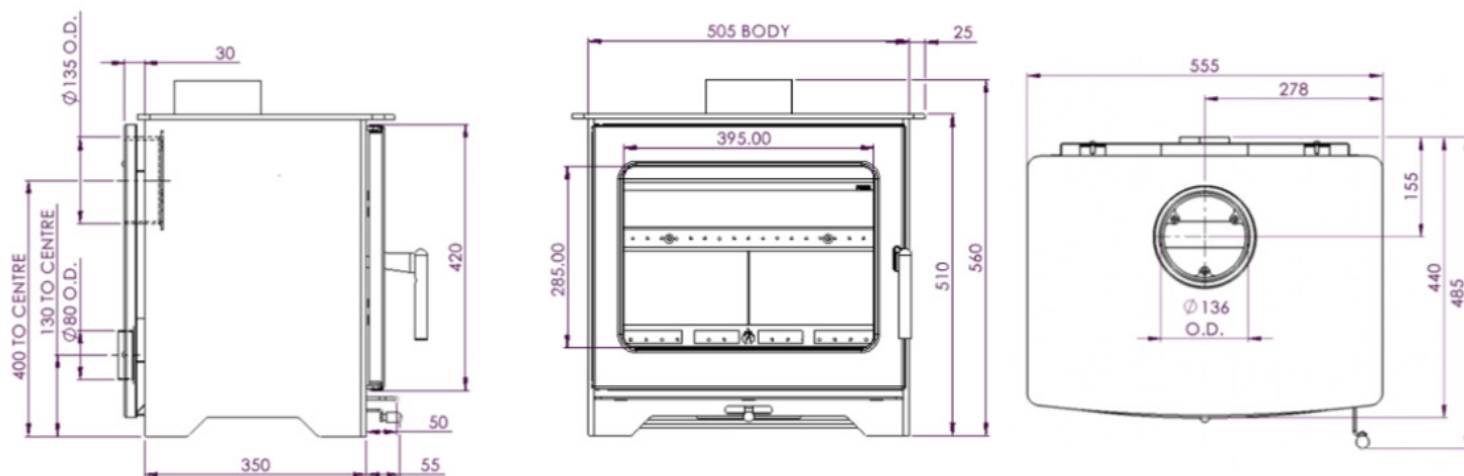

Data

| Distance To Combustible | Standard | | Convactor | | |
|-------------------------------|-------------|-------------|-----------|-------------------------|--------------------|
| | Single Wall | Single Wall | Twin Wall | Twin Wall & Heat Shield | |
| Rear Wall | 300 | 250 | 160 | 140 | mm |
| Side Wall | 450 | 250 | 200 | 200 | mm |
| Front | 1200 | 1200 | 1200 | 1200 | mm |
| Above | 460 | 460 | 460 | 460 | mm |
| Emission of CO | | | | 0.10 | % |
| Flue Gas Temperature | | | | 233 | °C |
| Flue Gas Mass Flow | | | | 3.7 | g/sec |
| Rated Output | | | | 5.0 | kW |
| Energy Efficiency | | | | 83.8 | % |
| Average Particulate Emissions | | | | 12 | mg/Nm ³ |
| OGC | | | | 74 | mg/Nm ³ |
| NOx | | | | 84 | mg/Nm ³ |
| Model Weight | | | | 93 | Kg |
| Hearth Temperature | | | | >100 | °C |
| Minimum Draught | | | | 12 | Pa |

All tests are carried out in accordance with BS EN 13240

USER OPERATING INSTRUCTIONS

Before use, please confirm with the installer that the appliance has been installed in accordance with the included instructions and that the flue/chimney has been correctly prepared/installed and commissioned. All local regulations including those referring to National or European standards are followed and complied with when installing the appliance.

As part of the commissioning and handover procedure, the installer must complete an in-person demonstration on how to correctly use to the appliance.

This appliance must not be installed in a shared flue system. The appliance is suitable for intermittent use and should not be operated in a continuous fashion. For example, overnight burning (slumbering). Ensure all sections of this manual are read before use.

Recommended Fuels

The Woodbridge 5 is a wood burning appliance. Only kiln dried or well seasoned logs with a moisture content of 20% or less are to be used.

Seasoned logs are typically barn dried or similar for a period of at least 12 months.

Hardwood species such as Ash, Beech & Oak are recommended as they produce a higher output than softwoods such as Pine or Cedar.

To achieve an approximate 5kW burn for 45 minutes we recommend the use of 2x 300mm (12") logs roughly 75mm (3") in diameter, along with 8-12 pieces of kindling 150-200mm (6-8") long stacked in a grid pattern.

Please Note

- Burning wet or unseasoned wood, or incorrect usage of the appliance may cause it to emit smoke which is illegal in smoke controlled areas. This will also heavily reduce the potential output of the appliance.
- Using wet or unseasoned wood may reduce the lifespan of the appliance and the flue system. Causing excessive smoke, leading to tar build-up in the flue increasing the risk of a chimney fire.
- Solid fuels such as Anthracite, Smokeless Coal, along with treated woods (e.g. pallets) are not permitted and will invalidate the warranty.
- The appliance is not to be used as an incinerator for household waste.
- Do not use liquid fuels or liquid firelighters.
- Do not over-fire the appliance by using more fuel than advised at one time. Overfiring can cause damage to the stove and surrounding areas.

Lighting & Refueling

These instructions only contain guidelines for operating your appliance. Your installer will show the best method for your installation as part of their in-person demonstration.

Please Note

During the initial week of use, to avoid damaging the paint or steel, recommend 3-4 small fires (kindling only). It is essential to let the appliance cool completely prior to preparing the next fire. This method gradually heats and cools the steel, prestressing the material, allowing the paint to cure correctly removing the risk of bubbling, peeling or flaking.

During this process, to properly cure the door & glass seals, we advise allowing the the stove to cool completely before opening the door.

- Do not leave the stove unattended whilst lighting.
- Do not operate the appliance with the door open with the exception of the instructions stated below.
- Whilst the stove is complete with a cool touch handle this will still get warm when in use. We recommend using the gloves provided when operating the handle or air control after ignition.

Initial Lighting

On initial lighting please ensure that the room is well ventilated with doors & windows open in necessary, as it is common for the stove to emit smoke and odour as the paint cures to the steel. Allow for the appliance to burn slowly for approximately 2-3 hours to evaporate any residual moisture within the flue/chimney.

Lighting

1. Move the air control to the far right.
2. Place 2 large pieces of split wood parallel in the fire box. It is advised to have the sawn ends facing sideways.
3. Stack 8-12 pieces of kindling above in a grid style pattern.
4. Ensure that the wood doesn't exceed the height of the tertiary air intake at the back of the stove (steel bar at rear), or spills over the log retainer.
5. Place 1-2 of your chosen firelighters in the top of the kindling and light it using a long match.
6. Close the door, if the kindling doesn't catch, then leave the door ajar for 2-3 minutes to provide an added boost of air to the firebox.
7. Once the kindling and logs have both caught well, open the door partially, wait a few moments, then open fully (to avoid drawing smoke out of the appliance).
8. Add additional fuel as required to the chamber, sitting perpendicular to the glass where possible.
9. Repeat step 6 if the new logs do not catch.
10. Once flames have appeared on the added logs, close the door fully.
11. Adjust the air control to the central position, after a few minutes this can be adjusted further to the left to obtain your desired burn.
12. Ensure the remaining ash is left in the appliance, this acts as an insulant and protects the base bricks in the appliance. Once the level of ash has reach the spillage point, remove roughly 3/4 and spread the remainder evenly across the base.

Refueling

To prevent slumbering, reduce smoke and emissions, it is important to refuel on a hot bed of embers. If no embers remain then the use of added kindling with the air control to the right and door ajar will aid the process. To refuel on an existing bed of embers:

1. Open the door partially, wait a few moments, then open fully.
2. Separate and spread the remaining fuel across the fire bed with an appropriate tool.
3. Place the correct quantity of fuel into the chamber, orientated perpendicular to the glass with space between the logs where possible.
4. Ensure the logs are not covering the tertiary air intake or overspilling the log retainer.
5. Move the air control to the far right position.
6. Close the door, if the logs do not catch, leave the door ajar until flames appear, and close the door again.
7. Once the new fuel has caught well and the temperature begins increases again, reposition the air control to the central point. This can be further adjusted down after a few minutes to achieve the desired burn.

Note:

Ensure the air control is in the far right position when refueling. Failure to do so will result in the appliance slumbering. This is detrimental to stove performance and can cause excessive smoke and condensation within the flue, leading to tar and soot build-up.

Ash Clearance

Ash should remain in the appliance, acting as an insulant and protecting the base bricks in the chamber. However, had the ash build to the point of spillage, or covers the lower holes in the rear fire bricks, it then needs to be removed.

- Always allow the ash to fully cool prior to removal, hidden embers in the ash can potentially reignite once disturbed and removed from the appliance.
- Ash should be removed with an appropriate tool and placed into a steel ash carrier.
- Once cooled, wood ash can then be used as a fertilizer for soil, or bagged and placed in with the household waste.

CONTROLS

Below are details of the air inlet positions. These are all controlled using the single air control lever on the front of the appliance.

| Air Inlet | Location |
|-----------|--|
| Primary | Bottom air inlet holes in the rear fire bricks of the appliance. This acts as a 'boost' function during ignition & refueling. |
| Secondary | An air wash which feeds air down behind the glass to keep it as clean as possible. |
| Tertiary | Upper air inlet on the steel bar at the rear of the appliance. Secondary and tertiary air combine, flowing over the fuel improving efficiency. |

Boost Setting

Fully open, positioned to the far right. Only required during initial ignition and refueling.

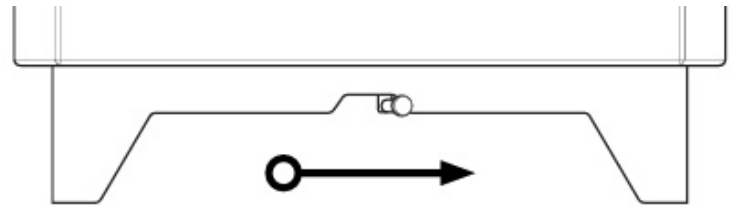

Nominal Setting

Primary inlet off. Exact nominal setting position will vary per installation, fuel and environmental factors.

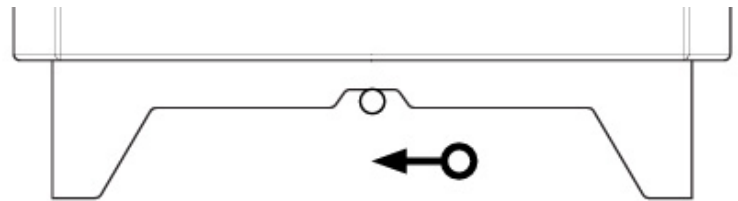

Minimum Setting

Primary inlet off. Minimal air supply to both secondary & tertiary inlets provided.

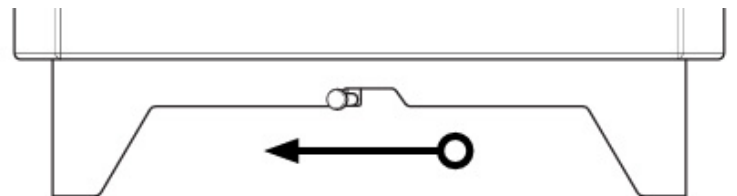

Smoke Control Setting

When fitted, this becomes the minimum setting in smoke controlled areas. Slide & screw into place, acting as a physical stop for the air control lever.

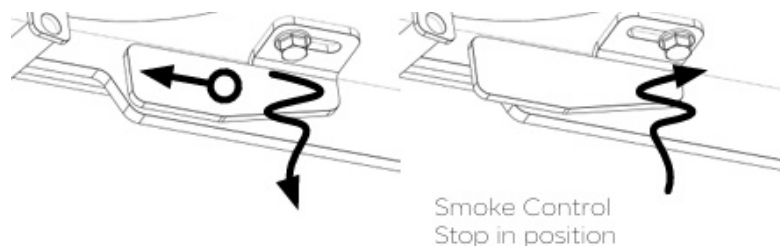

*View shown is underside of the appliance.

IMPORTANT NOTES

Fire Guards

A fireguard must always be used in the presence of children, the elderly or the infirm to ensure their safety. The fireguard must be manufactured in accordance with BS8423 - Fireguards for use with solid fuel appliances.

Warning Notes

When installed and operated correctly, this appliance will not emit fumes. Occasional fumes from maintenance and refueling may occur. Persistent fume emissions must not be accepted or tolerated.

This appliance must be operated with the door closed.

If fume emissions persist, the following actions should be made:

- Open all doors and windows to ventilate the space.
- Let the fire burn out, or safely eject and dispose of the fuel from the appliance.
- Have the installation checked for blockages in the flue/chimney and clean if required.
- Do not relight the appliance until the cause of the fume emissions have been identified and rectified.

If necessary, seek expert advice from registers installers and/or chimney sweeps.

If A Chimney Fire Occurs

- Raise the alarm.
- Call the fire brigade.
- Close all air controls to suffocate the fire.
- Move all furniture away from the appliance.
- If available, place a fireguard in front of the appliance.
- Check the chimney breast and/or wall for excessive heat and move all furniture/decorations away.
- Ensure there is clear passage for emergency services to enter.
- Evacuate the building.

It is paramount that the Fire Brigade can access your roof space in order to check for fire spread in other areas of the property.

Carbon Monoxide Detector

All new or replacement wood, solid fuel or biomass appliances installed within a dwelling now require the fitting of a carbon monoxide alarm under building regulations. This must be fitted in a suitable location within the same room of the appliance. The installation of an alarm is not considered a substitute for regular servicing or maintenance of an appliance. Further guidance can be found in the latest issue of BS EN 50292 and the alarm instructions.

Aerosols

Do not use an aerosol spray can on or near the appliance whilst under operation. There is a risk of flash ignition of the spray or explosion.

Extractor Fan

The fitting of a stove in a room containing any extractor fan should be avoided where possible. If unavoidable, the suitability of the installation location is at the qualified installers discretion. A flue draught test must be performed and a 'Direct Air Kit' installed if viable to do so.

Warning

The appliance will be hot whilst under any operation and due care should be taken.

Whilst a 'cool touch' handle is fitted, we advise the use of the gloves provided when operating the controls and handle.

Ventilation

It is essential that the appliance has adequate air supply for combustion and ventilation. Requirements of this can be found within Building Regulations Approved Document J. All ventilation for the appliance must remain clear and unrestricted.

SMOKE CONTROL AREAS

The Clean Air Act 1993 & Smoke Control Areas

Under the Clean Air Act local authorities may declare the whole or part of the district of the authority to be a smoke control area. It is an offence to emit smoke from a chimney of a building, furnace or any fixed boiler if located in a designated smoke control area. It is also an offence to acquire an 'unauthorized fuel' for use within a smoke control areas (unless used in an 'exempt' appliance from the controls which generally apply in the smoke control area).

In England appliances are exempted by publication on a list by the Secretary of State in accordance with changes made to sections 20 & 21 of the Clean Air Act 1993 by section 15 of the Deregulation Act 2015. In Scotland appliances are exempted by publication on a list by Scottish Ministers under section 50 of the Regulatory Reform (Scotland) Act 2014. In Wales & Northern Ireland these are authorised by regulations made by Welsh Ministers and the Department of the Environment respectively.

Your local authority is responsible for implementing the Clean Air Act 1993 including designation and supervision of smoke control areas. Further information can be found here: www.gov.uk/smoke-control-area-rules.

The Pevex Woodbridge 5 (V) has been recommended as suitable for use in smoke control areas when burning wood logs with a moisture content of 20% or less. The appliance must be fitted with a permanent stop preventing the closure of the secondary & tertiary air intake.

Refueling On A Low Firebed

If there is insufficient burning material remaining in the fire bed to light a new fuel charge, excessive smoke emission can occur. Refueling must be carried out on a sufficient amount of glowing embers & ash, to ensure ignition within a reasonable period of time. If the remaining material is insufficient then add additional kindling to prevent the emission of excessive smoke.

Fuel Overloading

The maximum amount of fuel specified within this manual should not be exceeded. Overload can cause excess smoke emissions.

Controls Left Open

Operation with the air controls fully open will result in incomplete combustion and excess smoke being produced. The appliance must not be operated with the air controls or door fully open except for where stated during lighting & refueling.

Operation With Door Open

The appliance is tested as a closed door appliance and must be used as such. Operation with the door open can cause excess smoke and fume spillage into the room. The door must remain closed in operation with the exception of where stated previously during lighting and refueling.

The Environment

To ensure a cleaner more environmentally friendly way of burning, avoid shutting the appliance down to the point where there are no visible flames in the chamber. When burnt this way the gases released from the wood will remain unburnt, leading to lower flue temperatures and condensation of soot in the chimney, which in turn can lead to a chimney fire. Said additional smoke will also carry an unpleasant smell polluting the surrounding area.

Remember that no matter how good the chimney may be, it will not perform well if the appliance is not operated correctly.

TROUBLESHOOTING

Smoke In The Room

This can happen for a variety of reasons with the most common being a cold flue (cold plug). The cooler air is denser, acting as a plug in the flue, preventing the hot gases and smoke from venting correctly and forcing it back down the flue and out of the stove. To avoid this we recommend pre-heating your flue with some kindling and firelighters. Ensuring the correct wood is used (hardwood with moisture less than 20%) is also key, damp and soft wood produce more smoke when burnt.

Weather Conditions

The weather and local atmospherics can play a big part in how the appliance will operate, especially in high winds. An anti-down draught cowl may be required in order to prevent serious issues, your installer will advise on the need for this.

Fog and mist can also cause issue requiring the need to alter how the appliance is used. Under these conditions a 'Cold Plug' is more common.

Operation Of The Fire

There are a variety of causes for problem with the appliance operation.

- Excessive (low or high) flue draught (speak with you installer for further advice).
- Incorrect use of air controls.
- Fuel quality & moisture content.
- Blockage in the flue, or external parameters (building and trees).

Fire Goes Out Quickly

- Check the flue draught isn't too high/low.
- Are all air vents unrestricted?
- Is there additional windows/doors open on an extractor fan in use?
- Inspect air controls.
- Ensure sufficient kindling/fuel is used.
- Preheat the chimney to enhance the draw.

Paint Curing

The paint curing process requires slow gentle burning to ensure the surface coating adheres correctly and free from fumes or odours. When completing the curing process we advise opening any door and windows to ensure the area is well ventilated.

If the surface of the stove appears to turn grey, flake or peel, this would be a sign of overfiring.

In the case the paint does bubble, peel, or flake, it's required to sand down the affected area and apply a new coat of paint which Pevex can provide.

Glass

Had you glass be blackening or not clearing when in use this will often be down to how the appliance is being operated. For example, the air control has been closed off too much. Alternatively poor quality fuel is a common cause due to a higher moisture content. If the glass obtains a white shadow (crazing) on the inside, this can be caused due to over-firing, too much primary air or a vacuum in the room.

Door Rope

Had the door sealing rope become loose, it can be caused by not completing the curing phase or overfiring the appliance. Reattach using stove rope adhesive, then follow the steps outlined in 'Lighting & Refueling' on page 4.

Noise

As the appliance heats and cools it is common to hear a ticking noise, this is the steel expanding and contracting under heat. This is normal and does not mean there is an issue with the appliance.

MAINTENANCE & SERVICING

Periods Of Prolonged Non-Use

If the stove is to be left unused for a prolonged period of time, it should be given a thorough clean to remove any ash and unburnt residue. To enable a good airflow through the appliance, reduce condensation and subsequent damage, leave the air controls fully open (far right position).

If the appliance hasn't been used for a long period, such as the warmer spring & summer months, a competent person should check the appliance and flue system for potential obstructions or faults. For example, have a chimney sweep completed before the start of the heating season.

Door/Glass Seals

Check the door rope seal periodically. If the rope has become detached in areas, use stove rope adhesive to reattach. Had the seal become worn or frayed, a replacement can be purchased from Pevex.

The glass seal will have to be replaced had a new piece of glass be required as this the self-adhesive side attaches to the glass itself. Over time the seal may also discolour, this is expected through general usage.

Glass Panel

Process to remove and replace the glass pane:

1. Ensure both the glass and seal is available to hand at the time of replacement.
2. Unscrew and remove the 4 glass retainer clips which hold the pane in place.
3. Remove the pane, the seal will be attached to this.
4. Fit the new glass seal to the pane.
5. When ready, hold the glass in position and replace the glass retaining clips. Ensure these are only hand tight to ensure expansion & contraction of the glass.

The glass can be cleaned using a damp soft cloth dipped into the wood ash, this acts as an abrasive to clean the residue. For tougher stains a purpose made glass cleaning solution may be required, if so apply this to the cloth rather than directly to the stove as it can run and soak into the seals.

The stove uses toughened glass capable of withstanding extreme heat. Typical causes for glass failures are accidental damage, slamming of the door, and fuel leaning heavily on the glass for a long period.

Firebricks & Log Retainer

In normal use, the firebricks can last for many years. It is possible however, due to improper loading, use or overfiring, for them to crack. Check periodically for cracks bricks, hairline cracks are ok, but anything larger than a £1 coin width should be replaced. Spares can be purchased from Pevex directly.

To remove the firebricks follow the steps below:

1. Lift the log retainer upwards at an angle to remove it from the stove.
2. Remove the base bricks.
3. Remove the baffle retainer pins in either side brick. These are designed to be a tight fit so can at times be tricky.
4. Lower and tilt the baffle at 45° to remove it.
5. Lift, pull forward then lower to remove the upper steel baffle.
6. Lean the side bricks in and remove one at a time.

Perform these steps in reverse to replace the components. Ensure the log retainer is sitting flat once completed.

Stove Body

The stove body can be wiped with a damp, lint free cloth. Any further scuffs/marks can be resprayed with paint available from Pevex.

Baffle Brick

The baffle brick is located in the roof of the appliance, this should be removed and cleaned periodically when in use (e.g. every 3 months). Doing so will prevent any build-up of ash or soot creating a blockage.

Chimney & Flue

The chimney/flue can be swept through the appliance with the baffle brick removed. For rear outlet installations this may still be possible or would require access via a tee cap or additional access door in the flue pipe - especially if this ensures the full flue length can be swept.

It is recommended for chimneys/flues connected to wood burning appliances to be swept by an experienced chimney sweep twice per year.

If the stove were fitted to an open chimney in place of an open fire, then the chimney should be swept prior to installation, and again a month following to ensure any material disturbed through the differing burning methods is cleared.

Annual Service

Peveex recommends that this appliance in any form of installation be serviced at least once annually, preferably prior to the heating season starting, ensuring that spare parts can be received in time if required. This should be carried out by your experienced chimney sweep.

- Removal of all internal components for cleaning and inspection.
- Sweep of the entire flue/chimney system - Those in thatched properties may require this along with a camera inspection twice per annum depending on their home insurers requirements.
- Removal of all ash and soot deposits within the appliance.
- Cleaning and inspection of all interior surfaces for damage/corrosion. If damage/corrosion were to be found, we advise you consult your sweep on rectifications or repairs.
- Inspection of all seals, glass and air controls. Glass cleaning may be offered within this if required to inspect fully.
- Check over of paint for damages, clean and respray if required.

Spare Parts

All spare parts can be purchased from Peveex directly. See spares parts list below for further details.

PLEASE NOTE: Only manufacturer recommended parts may be used

| Description | Product Code | Included In Warranty? |
|-------------------------------|--------------|-----------------------|
| Red Leather Gloves (Pair) | 00GLOVE | No |
| Senotherm Black Paint (400ml) | 08SENB | No |
| Brick set (Includes Baffle) | 08W5SET | No |
| Baffle Brick | 08W5B | No |
| Log Retainer | 08W5LR | No |
| Glass | 08W5G | No |
| Door Rope Kit | 08W5DRK | No |
| Glass Rope Kit | 08W5GRK | No |

Warning! Modifications are not permitted and will void your warranty

INSTALLATION INSTRUCTIONS

Competent Persons Scheme

Peveex recommend that this appliance be installed by a member of an accredited competent persons scheme e.g. Hetas, Oftec. This is also a requirement for the extended warranty scheme to then be valid.

If the installer is not a member of a competent persons scheme, it is then a legal requirement in the UK, to notify your Local Building Control Officer in advance of any installation works starting. This will also then reduce the provided warranty period to 1-year.

Legal Requirements

These instructions cover the basic principles to ensure satisfactory installation of the appliance, although details may require slight modification to suit particular local site conditions.

All local regulations, including those referring to National & European Standards need to be complied with when installing the appliance. In all cases the installation must comply with British Standard BS8303 Code of Practice for installation of domestic heating & cooking appliances burning solid fuel, current Building Regulations, Local Authority Bylaws, European & National Standards and other specifications or regulations.

Connection To The Chimney

Ensure any existing chimneys are clear of obstruction and have been swept prior to install. If fitting to a previously open fire the chimney must be swept again one month after install.

- An existing fireplace opening can be bricked up or sealed with a register plate with consideration for cleaning access (e.g. register plate with access door).
- A short length of 125mm internal flue pipe may be used to connect the stove to the chimney.
- This flue pipe must be of 316 stainless steel or vitreous enamel construction.
- Alternatively a twin wall starter length with a 0.9mm inner can be used off the top of the appliance.
- Twin wall components can also be used off the rear of the appliance.
- The horizontal section when connecting at the rear must not exceed 150mm in length.
- The horizontal section for rear connections can be increased to 450mm, provided that a flue calculation to BS EN 13884 has been carried out to check the draught.
- It is essential that all connections between the stove and chimney/flue are made airtight. Any bend in the chimney or connecting flue should not exceed 45°, 90° bends are not permitted.
- Provision made for cleaning access and debris removal to the chimney/flue.
- Single wall connecting flue should have a maximum length of 1.5m and only be located internally, converting to twin wall 450mm prior to the penetration point in the ceiling or external wall.

If found necessary to line the chimney then a twin wall flexible flue liner for solid fuel must be used. If there is no existing chimney then either a prefabricated block chimney or twin wall insulated stainless steel chimney to meet the requirements of the installation under standard BS EN 15287-1 can be used. These chimneys must be fitted in accordance with the requirements of BS EN 15287-1, manufacturer's instructions and Building Regulations Document J. Any connecting flue pipe systems must also meet these regulations.

Please check the suitability of the fireplace and/or surround for use with the appliance before installing it. If you have any doubts about the suitability of your chimney, please consult with your local installation engineer.

Hearth & Fire Surround

Hearth constructions must comply with the current Building Regulations. The stove must be installed on a floor with adequate load-bearing capacity; otherwise suitable measures should be taken. If the existing construction does not meet requirements, suitable measures (e.g. load distribution plate) should be put in place. The hearth should extend at least 400mm from the front of the appliance and at least 150mm to the sides. The stove door when open will extend beyond the hearth.

The standard Woodbridge 5 (& convector) should stand wholly on a constructional hearth, at least 125mm thick. The constructional hearth should be made of solid, non-combustible material, such as concrete or masonry, at least 125mm thick, including the thickness of any non-combustible decorative hearth (slate/granite) or flooring. Please refer to Building Regulations Approved Document J for further information.

Professional advice should be sought from your supplier or local building inspector if there is any doubt about the hearth positioning.

The fireplace should allow good air circulation and should be dimensioned to avoid overheating. A gap of 200mm each side and 300mm above the appliance should be sufficient. If a wooden beam is present then a minimum distance of 460mm (preferably 600mm) should be maintained. A protective shield may be required for the mantelpiece or beam in some situations. The distance behind the appliance to allow access must be a minimum of 50mm, but may need to be increased to meet Building Regulations.

Health & Safety Guidance

Special care must be taken when installing the appliance, such that the requirements of the Health & Safety at Work Act are met.

Handling

The appliance is heavy. Adequate facilities must be available for loading, unloading and site handling.

Metal Parts

When installing or servicing this appliance, care should be taken to avoid the possibility of personal injury.

Stove Performance

This is a domestic appliance and must only be used in accordance with these instructions.

Important Warning

This stove must be installed to a chimney that serves any other heating purpose.

Asbestos

This product contains no asbestos. If there is a possibility of asbestos in the installation then seek specialist guidance.

Fire Cement

Some fire cements are caustic and should not come into contact with skin. In case of contact, wash immediately with plenty of water.

Air Supply

The room or space containing this appliance does not need a permanent, unobstructed air opening unless the air permeability is less than $5\text{m}^3/(\text{h}\cdot\text{m}^2)$. Refer to Building Regulations Document J. If a draught stabiliser is fitted, refer to Building Regulations Document J. Due consideration should be given to all other appliances in the same room/space. All air openings must remain clear.

Certificate of Compliance

After completion of the appliance installation please ensure the Certificate of Compliance is completed by the installer to comply with the requirements of Hetas & Building Regulations. These details (including registration number) must be supplied by the installer to the homeowner for their insurance purposes.

Airtight Houses

Further attention is required in airtight houses where the design air permeability is less than $5\text{m}^3/(\text{h}\cdot\text{m}^2)$. Approved Document J & Appendix F gives further information. A window opening is not sufficient.

Distance To Combustible Materials

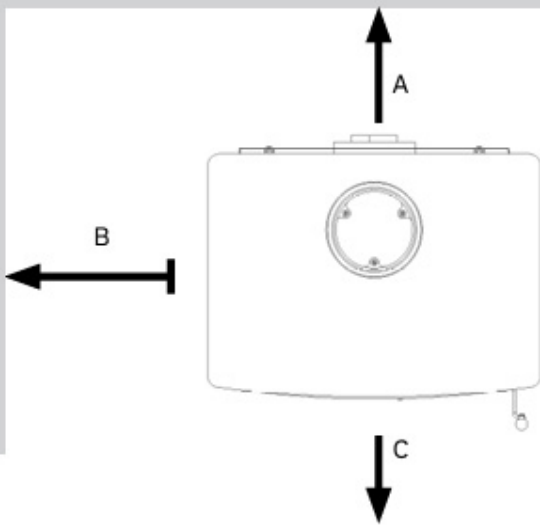

| | SW Flue | TW Flue & Heat Shield |
|---|---------|-----------------------|
| A | 250mm | 160mm |
| B | 250mm | 200mm |
| C | 1200mm | 1200mm |

When the appliance is to be installed within the vicinity of combustible walls the following minimum distances must be maintained.

Unpacking

Remove all packaging. Remove internal components to ease the handling of the appliance and protect them from damage during installation

- Instructions
- Gloves
- Firebricks
- Flue collar & fixings box

Data Plate



The data plate is attached to the rear of the appliance. This must remain accessible when the appliance is in its installed position.

Flue Collar & Blanking Plate

The flue collar and blanking plate can be removed and replaced in the opposite orientations to blank off the unused connection point.

Direct Air Kit

Had a direct air kit be required this can be purchased direct from Pevex.

|  WOODBIDGE 5 | |  | | |
|--|---------------------------------|---|-------------------|-------------------------|
| BS EN 13240: 2001+A2:2004 | | | | |
| Product Type | Room heater fired by solid fuel | | | |
| Intended Use | Residential room heater | | | |
| Fuel Type | Wood | | | |
| Minimum clearance to combustible materials (mm) | | | | |
| Flue | Single wall flue | Single wall | Twin wall | Twin wall + heat shield |
| Rear wall | 300 | 250 | 160 | 140 |
| Side wall | 450 | 250 | 200 | 200 |
| Front (e.g. furniture) | 1200 | 1200 | 1200 | 1200 |
| Emission of CO in combustion products | 0.10 | % | | |
| Flue gas temperature | 233 | °C | | |
| Flue gas mass flow | 3.7 | g/sec | | |
| Thermal output | 5.0 | kW | | |
| Energy efficiency | 83.8 | % | | |
| Average particulate emissions | 12 | mg/m ³ | | |
| | OGC | 74 | mg/m ³ | |
| | NOx | 84 | mg/m ³ | |
| Follow the user's instructions. | | | | |
| This stove must not be used in a shared flue. | | | | |
| Use only recommended fuels. | | | | |
| This stove is suitable for intermittent operation. | | | | |
| Pevex Enterprises Ltd., Unit MP7 Kirrawah Business Park, Newbourn Road, Waldringfield, Near Woodbridge, IP12 4PR | | | | |

Commissioning

Check that the firebricks and baffle brick are all fitted correctly, and that the door closes properly.

Once the installations is complete allow sufficient time for any fire cement or building work to dry out properly before lighting the appliance.

Commission the appliance in line with BS EN 15287-1 & Building Regulation requirements. Check that fumes and smoke are emitted safely from the top of the chimney.

On satisfactory completion of the commissioning process leave these instructions with the customer and run through the following details with them adding any useful information dependent upon their particular location or installation:

- Safety
- CO Alarm
- Recommended Fuels
- Lighting
- Refueling
- What to do in the event of a chimney fire
- Troubleshooting
- Maintenance
- Chimney Sweeping
- Annual Servicing

Recycling

To dispose of the stove after product life has expired, please observe the following information:

- Dispose of the items correctly i.e. separate the parts to be disposed of in material groups.
- Always dispose of items in a way that is as sustainable as possible and that is in line with the current environmental protection, reprocessing/recycling disposal technology.

Warranty Scheme

The chassis of the Woodbridge 5 comes with a standard 1-year warranty from the date of purchase. We also offer an extended 5-year warranty for those purchased and installed by an authorised PeveX stockist. Consumable items such as firebricks, glass etc are not covered.

Warranty Registration

To obtain the extended 5-year warranty the installation must be registered with us within 28 days of installation. In order to register the warranty for your appliance please scan the QR code below or visit our website - pevexstoves.co.uk



PeveX Enterprises Ltd, Unit MP7 Kirrawah Business Park, Newbourne Road,
Waldringfield, Nr Woodbridge, IP12 4PR